

MP41 High Precision Digital Pressure Switch



Features

- Hysteresis adjustable.
- High accuracy and Resolution.
- Low cost.
- Pressure unit selectable : MPa, kgf/cm², bar, psi.

Specification

Model		MP41P (Positive)		
Rated pressure range		0.000 ~ 1.000 MPa		
Setting pressure range		-0.100 ~ 1.000 MPa		
Withstand pressure		1.5 Mpa		
Fluid		Air, Non-corrosive gases, incombustible gases		
Set pressure resolution	MPa	0.001		
	kgf/cm ²	0.01		
	bar	0.01		
	psi	0.1		
Power supply voltage		12 to 24V DC $\pm 10\%$, Ripple (P-P) 10% or less		
Current consumption		≤ 40 mA (With no load)		
Switch output		<table border="0" style="width: 100%;"> <tr> <td style="width: 50%; text-align: center;"> NPN open collector Max. load current : 125mA Max. supply voltage: 30V DC Residual voltage : ≤ 1.5V (load current 125mA) </td> <td style="width: 50%; text-align: center;"> PNP open collector Max. load current : 125mA Max. supply voltage: 24V DC Residual voltage : ≤ 1.5V (load current 125mA) </td> </tr> </table>	NPN open collector Max. load current : 125mA Max. supply voltage: 30V DC Residual voltage : ≤ 1.5 V (load current 125mA)	PNP open collector Max. load current : 125mA Max. supply voltage: 24V DC Residual voltage : ≤ 1.5 V (load current 125mA)
NPN open collector Max. load current : 125mA Max. supply voltage: 30V DC Residual voltage : ≤ 1.5 V (load current 125mA)	PNP open collector Max. load current : 125mA Max. supply voltage: 24V DC Residual voltage : ≤ 1.5 V (load current 125mA)			
Repeatability (Switch output)		$\leq \pm 0.2\%$ F. S. ± 1 digit		
Hysteresis	One point set mode	Adjustable		
	Hysteresis mode			
	Window com parat or mode			
Response time		Chattering-proof function: 0.05s, 0.25s, 0.5s, 1s, 2s and 3s selections		
Output short circuit protection		Yes		
7 segment LED display		Two color(Red/Green) main & unit display, Orange sub-display (Sampling rate: 5 times/1sec.)		
Indicator accuracy		$\leq \pm 2\%$ F.S. ± 1 digit (ambient temperature: 25 $\pm 3^\circ$ C)		
Switch ON Indicator		Orange OUT 1 Indicator		
Environment	Enclosure	IP40		
	Ambient temp. range	Operation: 0 ~ 50°C, storage: -10 ~ 60°C (No condensation or freezing)		
	Ambient humidity range	Operation/Storage: 35 ~ 85% RH (No condensation)		
	Withstand voltage	1000V AC in 1-min. (between case and lead wire)		
	Insulation resistance	50Mohm min. (at 500VDC between case and lead wire)		
	Vibration	Total amplitude 1.5mm or 10G, 10Hz-150Hz-10Hz scan for 1 minute, two hours each direction of X,Y and Z		
Shock		100m/s ² (10G), 3 times each in direction of X,Y and Z		
Temperature characteristic		$\leq \pm 2\%$ F.S. of detected pressure (25°C) at temp. Range of 0~50°C		
Lead wire		Oil-resistance cable(0.15mm ²)		
Weight		Approx 6 g (with 2-meter lead wire), Approx 30g (with male connector)		

Output circuit wiring graph

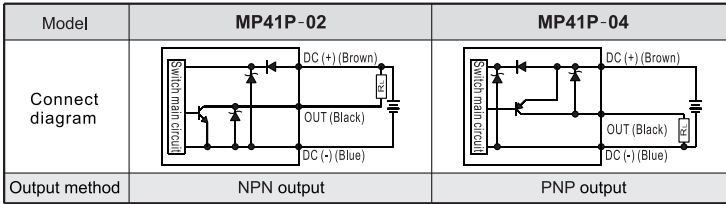

How to order

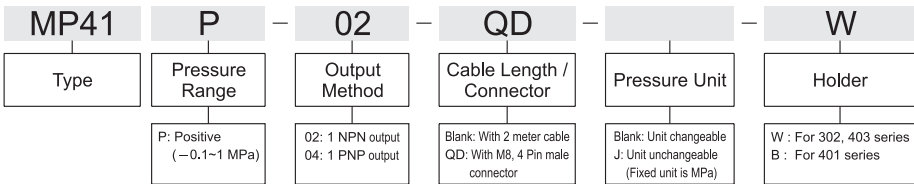

- UVSC
- UACP
- UAFR
- UAR
- ADV FMRF
- MP PG

Applicable model

Series	302	401	403
F.R.L.Unit	UACP302	UACP401	UACP403
F.R.Unit	UAFR302	UAFR401	UAFR403
R. Unit	UAR302	UAR401	UAR403

Unit dimension

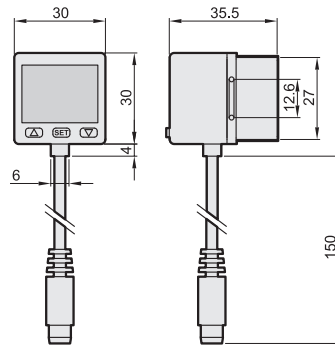

Panel instructions

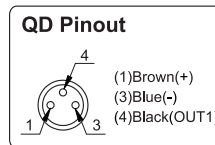
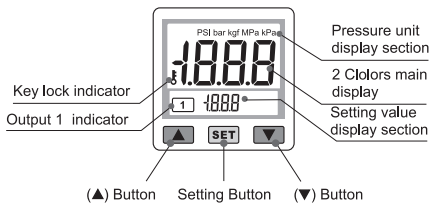

MP41 High Precision Digital Pressure Switch



Mounting procedures

1. Fix the holder.
2. Assembly the digital pressure switch.
3. Button the n-ring.

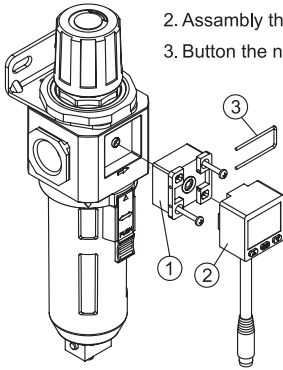

Symbol

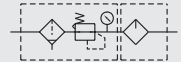

How to order (Air Units)

UACP302	8A		E3		G
Type	Bore		Pressure Switch	Filter Element	Port Thread
UACP302 UAFR302 UAR302	8A : 1/4 10A : 3/8 15A : 1/2	Blank: standard type D: auto drain valve (FMRF300)	E1: MP41P-02 E2: MP41P-02-QD E3: MP41P-02-J E4: MP41P-02-QD-J E5: MP41P-04 E6: MP41P-04-QD E7: MP41P-04-J E8: MP41P-04-QD-J	Blank: 5 μ m 40 μ : 40 μ m	Blank: Rc thread G: G thread NPT: NPT thread

※ Not applicable to UAR302

● UAR302

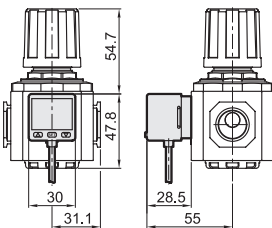

● UAFR302

● UAFR302-D

Auto drain valve
Operating pressure range:
0.15~1 MPa

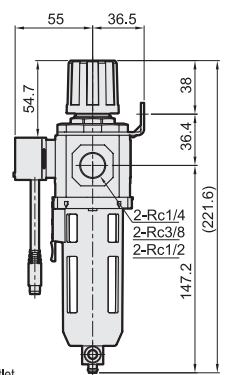
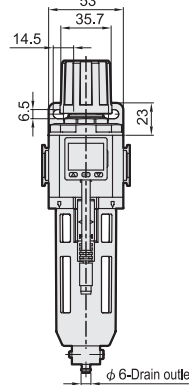
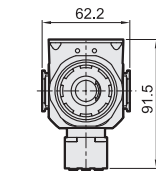
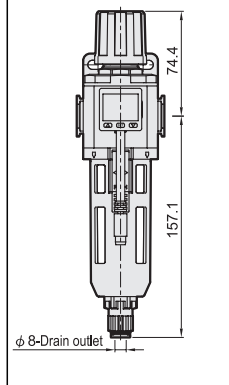

MP41 High Precision Digital Pressure Switch



Mounting procedures

1. Fix the holder.
2. Assembly the digital pressure switch.
3. Button the n-ring.

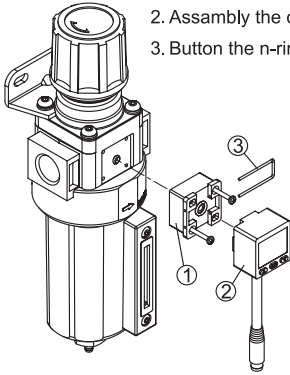

Symbol

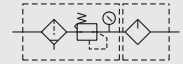

UVSC

UACP

UAFR

UAR

ADV
FMRF

MP
PG

How to order (Air Units)

UACP401	8A		E3	G
Type	Bore		Pressure Switch	Filter Element
UACP401 UAFR401 UAR401	8A : 1/4 10A : 3/8 15A : 1/2	Blank: standard type D: auto drain valve (FMRF300) ※ Not applicable to UAR401	E1: MP41P-02 E2: MP41P-02-QD E3: MP41P-02-J E4: MP41P-02-QD-J E5: MP41P-04 E6: MP41P-04-QD E7: MP41P-04-J E8: MP41P-04-QD-J	Blank: 40 μm 5u: 5 μm Blank: Rc thread G: G thread NPT: NPT thread

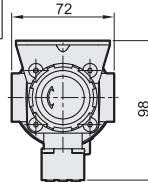

● UAR401

● UAFR401

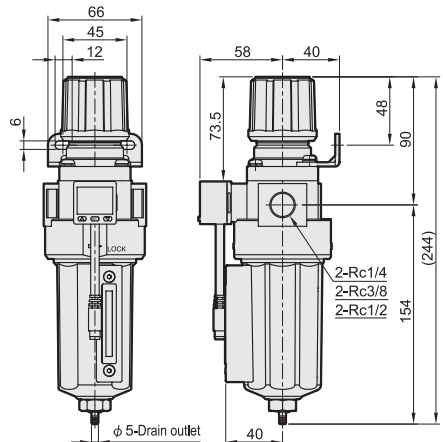
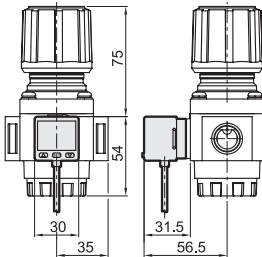

MP41 High Precision Digital Pressure Switch



Mounting procedures

1. Fix the holder.
2. Assembly the digital pressure switch.
3. Button the n-ring.

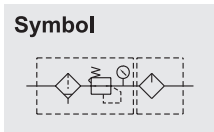
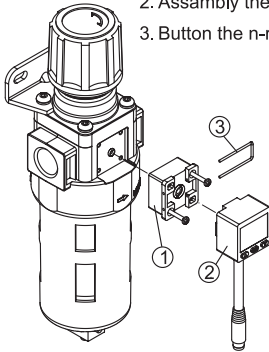

How to order (Air Units)

UACP403	8A		E3		G
Type	Bore		Pressure Switch	Filter Element	Port Thread
UACP403 UAFR403 UAR403	8A : 1/4 10A : 3/8 15A : 1/2	Blank: standard type D: auto drain valve (FMRF300)	E1: MP41P-02 E2: MP41P-02-QD E3: MP41P-02-J E4: MP41P-02-QD-J E5: MP41P-04 E6: MP41P-04-QD E7: MP41P-04-J E8: MP41P-04-QD-J	Blank: 40 μm 5u: 5 μm	Blank: Rc thread G: G thread NPT: NPT thread

※Not applicable to UAR403

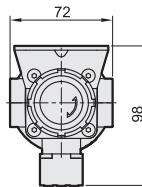

● UAR403

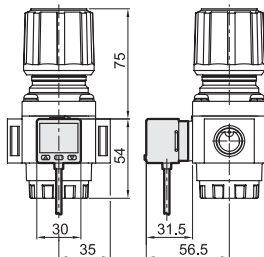

● UAFR403

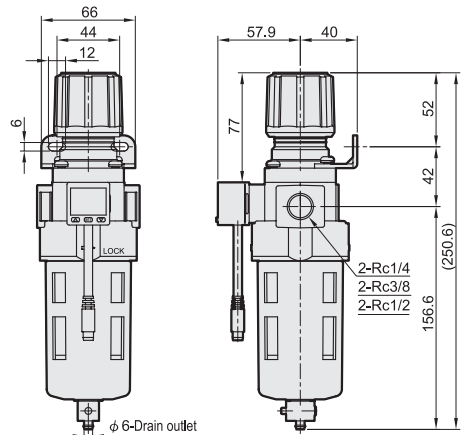

Specification

Model	MPS-6A	MPS-6A-R
Fitting method	PT 1/8 (for pipe-thread fitting)	O-ring: S4 (for O-ring fitting)
Ambient temperature	-5~+60°C (No freezing)	
Operating pressure range	0.8 MPa	
Test pressure	1 MPa	
Pressure setting range	0.1~0.7 MPa	
Operation output	Normal open ON (Red led lighting up) above value	
Sensor switch	RCE Reed switch / Normal open Voltage range: 5~220V DC/AC Max. Current: 50mA	
Weight	185 g	189 g



Symbol

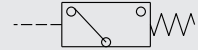

UVSC

UACP

UAFR

UAR

ADV
FMRF

MP
PG

How to order

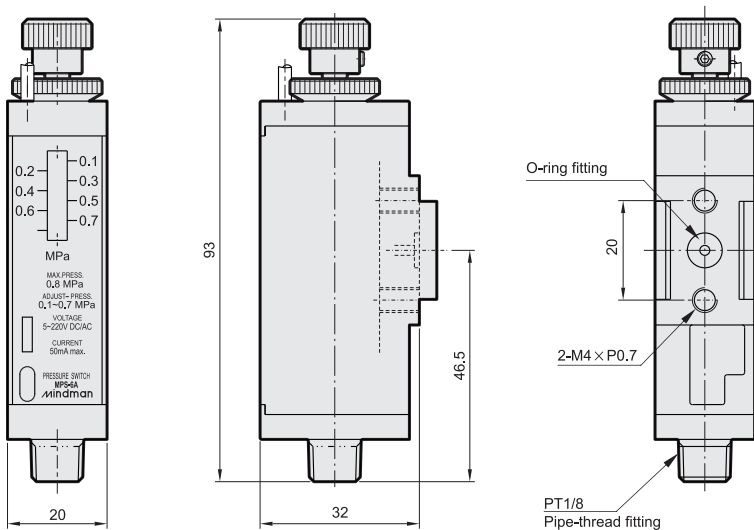
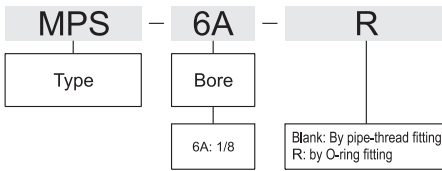

Specification

Model	PG-20	PG-40
Bore No.	—	6A
Port size	—	1/8
Medium	Air	
Operating pressure range	By order specifications	
Ambient temperature	-5~+60°C (No freezing)	
Precision	JIS 4.0 Class	
Weight	11 g	54 g



PG-40



PG-20

How to order

PG - **40** - **S** - **1K** - **NPT**

Type Gauge Size Case Material Press. Range Port Thread

Code Model	—	W	S	Note
PG-20	○	○	×	W(White)
PG-40	○	○	○	W(Electroplating)

※ Blank: Standard type (Black)
 ※ S: Stainless steel

Blank: 0~1 MPa
 1K : 0~0.1 MPa
 2K : 0~0.2 MPa
 3K : 0~0.3 MPa
 4K : 0~0.4 MPa
 5K : 0~0.5 MPa
 20K : 0~2 MPa

Pressure Range

Code Model	—	1K	2K	3K	4K	5K	20K
PG-20	○	×	×	×	×	×	×
PG-20W	○	×	×	×	×	×	×
PG-40	○	○	○	○	○	○	○
PG-40W	○	○	○	○	○	○	○
PG-40S	○	×	○	×	○	×	×

● PG-20

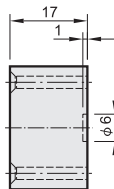
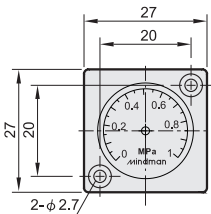

● PG-40

