

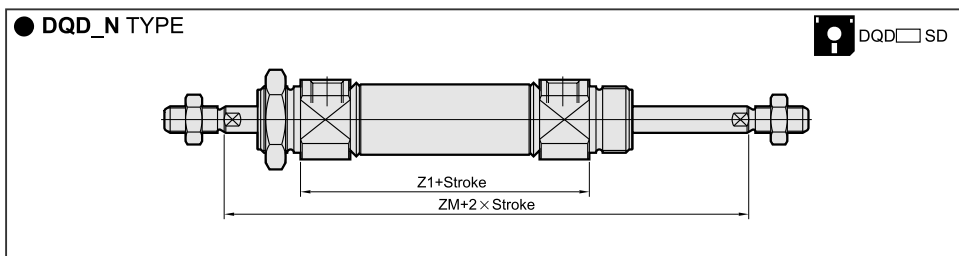

Dimensional features of double acting cylinders

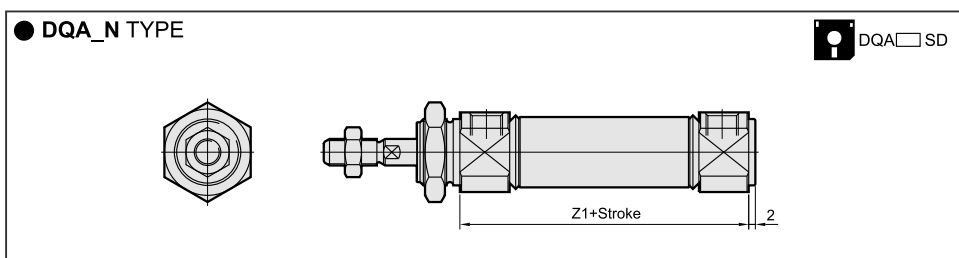
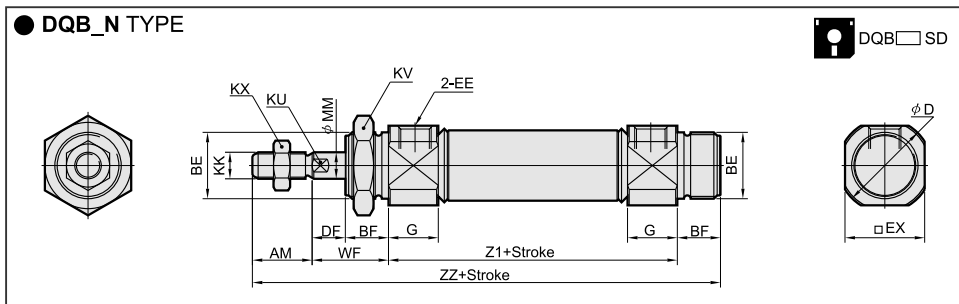

Dimensional Table

Bore	AM	BE	BF	D	DF	EE	EX	G	KK	KU	KV	KX	MM	WF	Z1	ZM	ZZ
φ 20	18	M20 × 1.5	13	28	10	G 1/8	24	15	M8 × 1.25	7	27	14	8	23	62	108	116
φ 25	22	M26 × 1.5	13	33.5	10	G 1/8	30	15	M10 × 1.25	9	32	17	10	23	62	108	120
φ 32	22	M26 × 1.5	13	37.5	10	G 1/8	34.5	15	M10 × 1.25	10	32	17	12	23	64	110	122
φ 40	24	M32 × 2.0	16	46.5	10	G 1/4	42.5	21.5	M14 × 1.5	14	41	22	16	26	88	140	154

- DA
- DP
- DS
- DQ
- DB
- DN
- BN
- ST
- NT
- DU
- DJ
- TA
- GP
- GS
- GM
- GT
- RT
- CT
- CH



Dimensional features of double acting cylinders

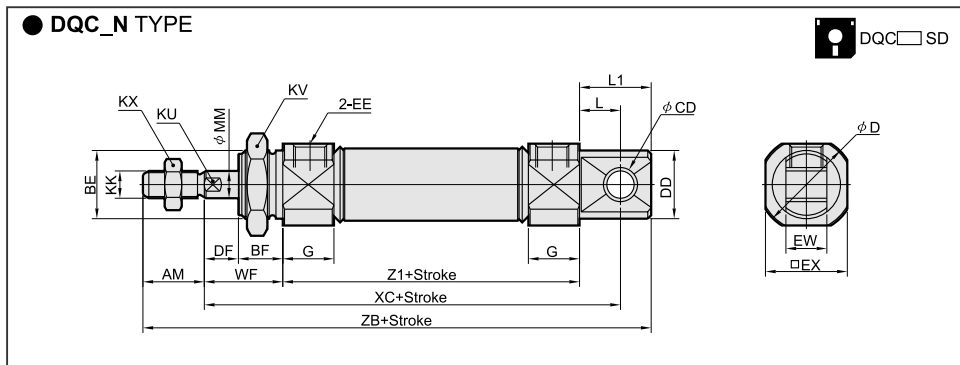

Dimensional Table

Bore	AM	BE	BF	CD	D	DD	DF	EE	EX	EW	G	KK	KU	KV	KX	L	L1	MM	WF	XC	Z1	ZB
φ 20	18	M20×1.5	13	8	28	20	10	G 1/8	24	12	15	M8×1.25	7	27	14	12	21	8	23	97	62	124
φ 25	22	M26×1.5	13	8	33.5	22	10	G 1/8	30	12	15	M10×1.25	9	32	17	12	21	10	23	97	62	128
φ 32	22	M26×1.5	13	10	37.5	27	10	G 1/8	34.5	20	15	M10×1.25	10	32	17	15	27	12	23	102	64	136
φ 40	24	M32×2.0	16	10	46.5	33	10	G 1/4	42.5	20	21.5	M14×1.5	14	41	22	15	27	16	26	129	88	165

Mounting Dimension of Double Acting Cylinders

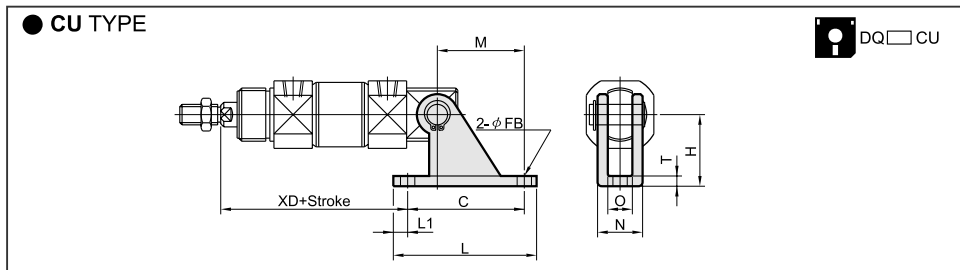

Dimensional Table

Type	Bore	C	FB	H	L	L1	M	N	O	T	XD
CU-20	φ 20	45	6.8	30	59	7	30	18.4	12	3.2	82
CU-25	φ 25	45	6.8	30	59	7	30	18.4	12	3.2	82
CU-32	φ 32	55	9	40	75	10	40	28	20	4	87
CU-40	φ 40	55	9	40	75	10	40	28	20	4	114



Mounting Dimension of Double Acting Cylinders

● FA(FB) TYPE

Bore φ 20 ~ φ 32

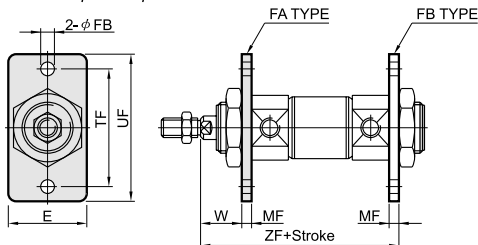

Bore φ 40

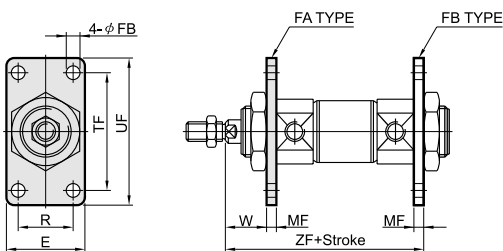

Dimensional Table

Type	Bore	E	FB	MF	R	TF	UF
FA-20	φ 20	34	7	4	-	60	75
FA-25	φ 25	40	7	4	-	60	75
FA-32	φ 32	40	7	4	-	60	75
FA-40	φ 40	52	7	5	36	66	82

Type	Bore	W	ZF
FA-20	φ 20	19	89
FA-25	φ 25	19	89
FA-32	φ 32	19	91
FA-40	φ 40	21	119

● LB TYPE

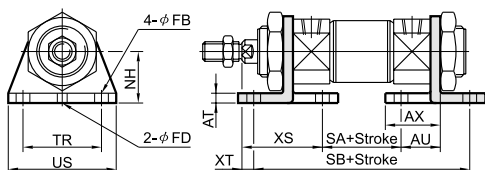

Dimensional Table

Type	Bore	AT	AU	AX	FB	FD	NH
LB-20	φ 20	3.2	20	28	7	4	25
LB-25	φ 25	3.2	20	28	7	4	28
LB-32	φ 32	3.2	20	28	7	4	28
LB-40	φ 40	3.2	23	33	7	4	30

Type	Bore	SA	SB	TR	US	XT	XS
LB-20	φ 20	28.4	102	40	55	3	39.8
LB-25	φ 25	28.4	102	40	55	3	39.8
LB-32	φ 32	30.4	104	40	55	3	39.8
LB-40	φ 40	48.4	134	55	75	3	45.8

● TA(TB) TYPE

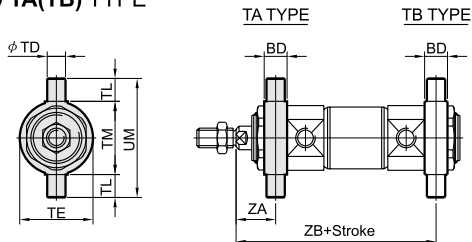

Dimensional Table

Type	Bore	BD	TD	TE	TL	TM	UM
TA-20	φ 20	10	8	32	10	32	52
TA-25	φ 25	10	9	40	10	40	60
TA-32	φ 32	10	9	40	10	40	60
TA-40	φ 40	11	10	53	12	53	77

Type	Bore	ZA	ZB
TA-20	φ 20	18	90
TA-25	φ 25	18	90
TA-32	φ 32	18	92
TA-40	φ 40	20.5	119.5

- DA
- DP
- DS
- DQ**
- DB
- DN
- BN
- ST
- NT
- DU
- DJ
- TA
- GP
- GS
- GM
- GT
- RT
- CT
- CH



Mounting Dimension of Double Acting Cylinders

● FA TYPE

Bore φ 20 ~ φ 32

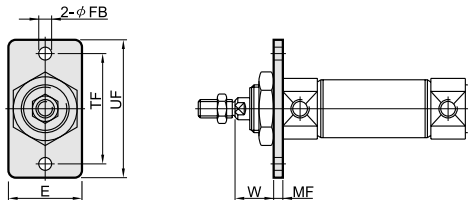

Bore φ 40

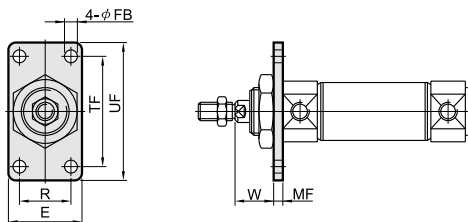

Dimensional Table

Type	Bore	E	FB	MF	R	TF
FA-20	φ 20	34	7	4	-	60
FA-25	φ 25	40	7	4	-	60
FA-32	φ 32	40	7	4	-	60
FA-40	φ 40	52	7	5	36	66

Type	Bore	UF	W			
FA-20	φ 20	75	19			
FA-25	φ 25	75	19			
FA-32	φ 32	75	19			
FA-40	φ 40	82	21			

● TA TYPE

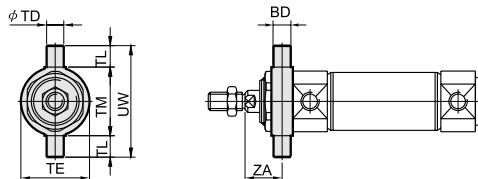

Dimensional Table

Type	Bore	BD	TD	TE	TL	TM
TA-20	φ 20	10	8	32	10	32
TA-25	φ 25	10	9	40	10	40
TA-32	φ 32	10	9	40	10	40
TA-40	φ 40	11	10	53	12	53

Type	Bore	UM	ZA			
TA-20	φ 20	52	18			
TA-25	φ 25	60	18			
TA-32	φ 32	60	18			
TA-40	φ 40	77	20,5			



Mounting Dimension of Double Acting Cylinders

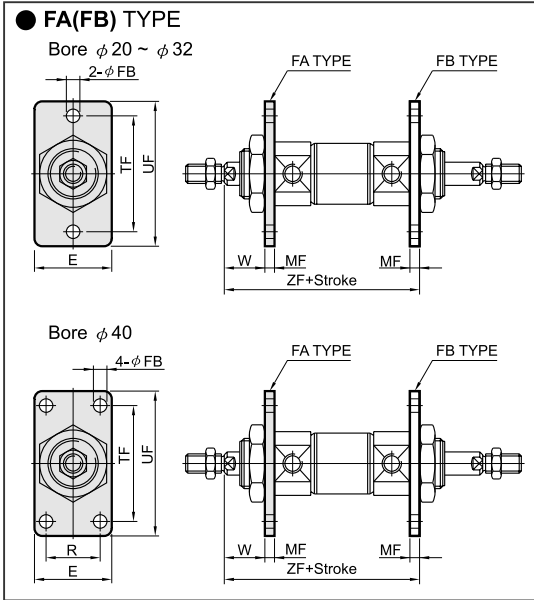

Dimensional Table

Type	Bore	E	FB	MF	R	TF	UF
FA-20	φ 20	34	7	4	-	60	75
FA-25	φ 25	40	7	4	-	60	75
FA-32	φ 32	40	7	4	-	60	75
FA-40	φ 40	52	7	5	36	66	82

Type	Bore	W	ZF
FA-20	φ 20	19	89
FA-25	φ 25	19	89
FA-32	φ 32	19	91
FA-40	φ 40	21	119

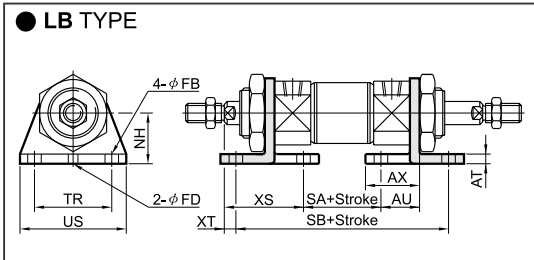

Dimensional Table

Type	Bore	AT	AU	AX	FB	FD	NH
LB-20	φ 20	3.2	20	28	7	4	25
LB-25	φ 25	3.2	20	28	7	4	28
LB-32	φ 32	3.2	20	28	7	4	28
LB-40	φ 40	3.2	23	33	7	4	30

Type	Bore	SA	SB	TR	US	XT	XS
LB-20	φ 20	28.4	102	40	55	3	39.8
LB-25	φ 25	28.4	102	40	55	3	39.8
LB-32	φ 32	30.4	104	40	55	3	39.8
LB-40	φ 40	48.4	134	55	75	3	45.8

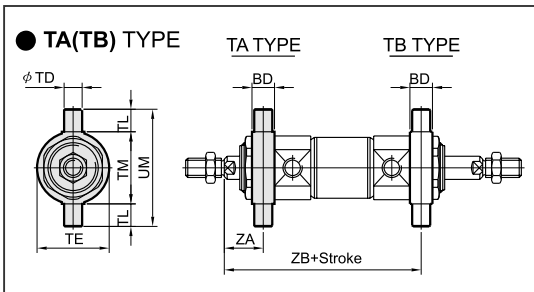

Dimensional Table

Type	Bore	BD	TD	TE	TL	TM	UM
TA-20	φ 20	10	8	32	10	32	52
TA-25	φ 25	10	9	40	10	40	60
TA-32	φ 32	10	9	40	10	40	60
TA-40	φ 40	11	10	53	12	53	77

Type	Bore	ZA	ZB
TA-20	φ 20	18	90
TA-25	φ 25	18	90
TA-32	φ 32	18	92
TA-40	φ 40	20.5	119.5

- DA
- DP
- DS
- DQ**
- DB
- DN
- BN
- ST
- NT
- DU
- DJ
- TA
- GP
- GS
- GM
- GT
- RT
- CT
- CH

Accessories

● Y Rod Clevis (With Pin)

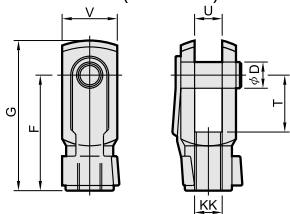

Dimensional Table

Type	Bore	D	F	G	KK	T	U	V
Y-M8 × 1.25	φ 20	8	32	42	M8 × 1.25	16	8	16
Y-M10 × 1.25	φ 25, φ 32	10	40	52	M10 × 1.25	20	10	20
Y-M14 × 1.5	φ 40	10	45	58	M14 × 1.5	20	14	25



Type	Filename
Y-M8 × 1.25	YM08125
Y-M10 × 1.25	YM10125
Y-M14 × 1.5	YM14150

● I Rod end mounting

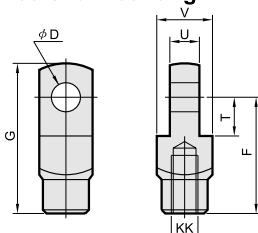

Dimensional Table

Type	Bore	D	F	G	KK	T	U	V
I-M8 × 1.25	φ 20	8	32	42	M8 × 1.25	11	8	16
I-M10 × 1.25	φ 25, φ 32	10	40	52	M10 × 1.25	13	10	19
I-M14 × 1.5	φ 40	10	45	57	M14 × 1.5	13	14	25.4



Type	Filename
I-M8 × 1.25	IM08125
I-M10 × 1.25	IM10125
I-M14 × 1.5	IM14150

● Oscillating Eye

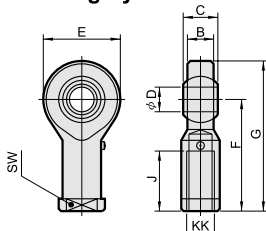

Dimensional Table

Type	Bore	B	C	D	E	F	G	J	KK	SW
G-M8 × 1.25	φ 20	9	12	8	22	36	47	17	M8 × 1.25	14
G-M10 × 1.25	φ 25, φ 32	10.5	14	10	26	43	56	21	M10 × 1.25	17
G-M14 × 1.5	φ 40	13.5	19	14	34	57	74	27	M14 × 1.5	22



Type	Filename
G-M8 × 1.25	GM08125
G-M10 × 1.25	GM10125
G-M14 × 1.5	GM14150

● Compensating Joint

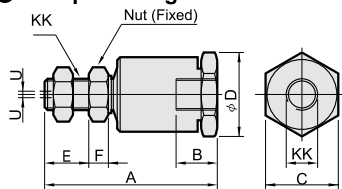

Dimensional Table

Type	Bore	A	B	C	D	E	F	KK	U
K-M8 × 1.25	φ 20	47	11	19	20	14.5	5	M8 × 1.25	0.75
K-M10 × 1.25	φ 25, φ 32	54	13	24	25.5	14.5	6	M10 × 1.25	1
K-M14 × 1.5	φ 40	70	17	29	31	19	8	M14 × 1.5	1.15



Type	Filename
K-M8 × 1.25	KM08125
K-M10 × 1.25	KM10125
K-M14 × 1.5	KM14150

● Mounting Nut

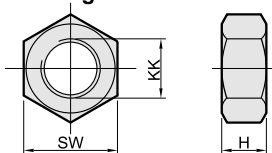

Dimensional Table

Type	Bore	H	KK	SW	Type	Filename
N-M8 × 1.25	φ 20	5	M8 × 1.25	14	N-M8 × 1.25	NM08125
N-M10 × 1.25	φ 25, φ 32	6	M10 × 1.25	17	N-M10 × 1.25	NM10125
N-M14 × 1.5	φ 40	8	M14 × 1.5	22	N-M14 × 1.5	NM14150
N-M20 × 1.5	φ 20	8	M20 × 1.5	27	N-M20 × 1.5	NM20150
N-M26 × 1.5	φ 25, φ 32	8	M26 × 1.5	32	N-M26 × 1.5	NM26150
N-M32 × 2.0	φ 40	8	M32 × 2.0	41	N-M32 × 2.0	NM32200





Dimensional features of single acting cylinders (with end cushion)

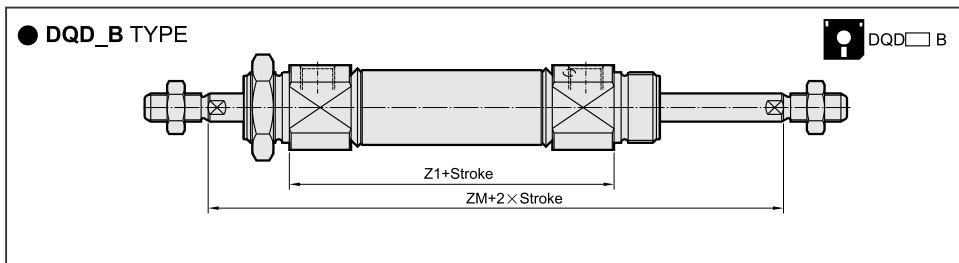
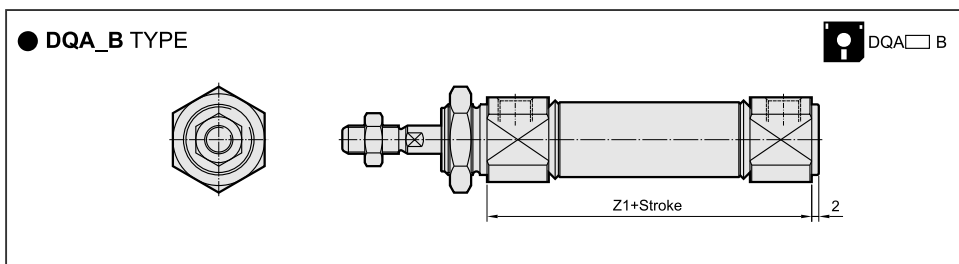
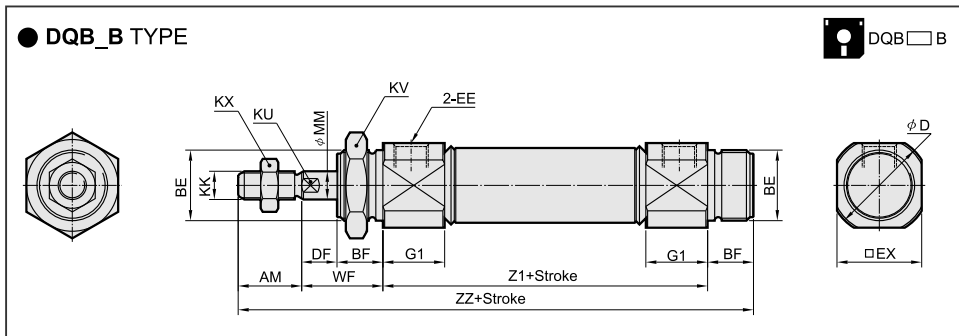

Dimensional Table

Bore	AM	BE	BF	D	DF	EE	EX	G1	KK	KU	KV	KX	MM	WF	Z1	ZM	ZZ
φ 20	18	M20×1.5	13	28	10	G 1/8	24	17.5	M8×1.25	7	27	14	8	23	62	108	116
φ 25	22	M26×1.5	13	33.5	10	G 1/8	30	17.5	M10×1.25	9	32	17	10	23	62	108	120
φ 32	22	M26×1.5	13	37.5	10	G 1/8	34.5	17.5	M10×1.25	10	32	17	12	23	64	110	122
φ 40	24	M32×2.0	16	46.5	10	G 1/4	42.5	21.5	M14×1.5	14	41	22	16	26	88	140	154

DA

DP

DS

DQ

DB

DN

BN

ST

NT

DU

DJ

TA

GP

GS

GM

GT

RT

CT

CH



Dimensional features of single acting cylinders (with end cushion)

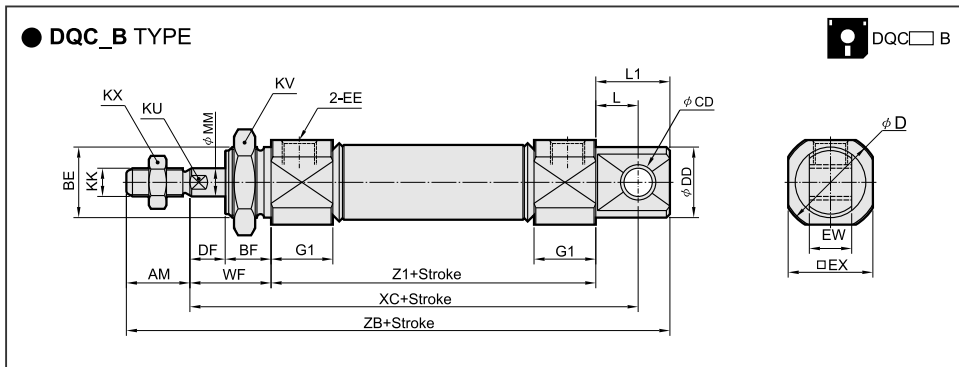

Dimensional Table

Bore	AM	BE	BF	CD	D	DD	DF	EE	EX	EW	G1	KK	KU	KV	KX	L	L1	MM	WF	XC	Z1	ZB
φ 20	18	M20×1.5	13	8	28	20	10	G 1/8	24	12	17.5	M8×1.25	7	27	14	12	21	8	23	97	62	124
φ 25	22	M26×1.5	13	8	33.5	22	10	G 1/8	30	12	17.5	M10×1.25	9	32	17	12	21	10	23	97	62	128
φ 32	22	M26×1.5	13	10	37.5	27	10	G 1/8	34.5	20	17.5	M10×1.25	10	32	17	15	27	12	23	102	64	136
φ 40	24	M32×2.0	16	10	46.5	33	10	G 1/4	42.5	20	21.5	M14×1.5	14	41	22	15	27	16	26	129	88	165

Mounting Dimension of Double Acting Cylinders (with end cushion)

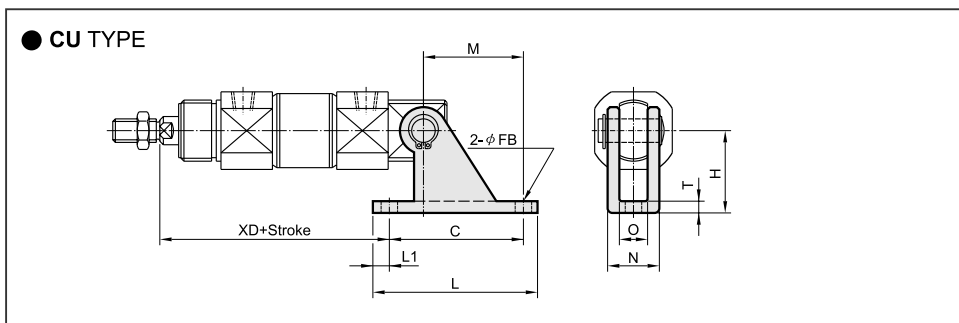

Dimensional Table

Type	Bore	C	FB	H	L	L1	M	N	O	T	XD
CU-20	φ 20	45	6.8	30	59	7	30	18.4	12	3.2	82
CU-25	φ 25	45	6.8	30	59	7	30	18.4	12	3.2	82
CU-32	φ 32	55	9	40	75	10	40	28	20	4	87
CU-40	φ 40	55	9	40	75	10	40	28	20	4	114



Mounting Dimension of Double Acting Cylinders (with end cushion)

●FA(FB) TYPE

Bore φ 20 ~ φ 32

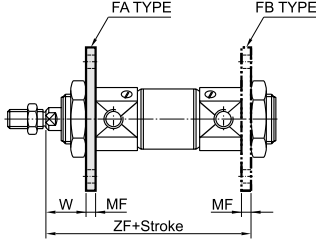
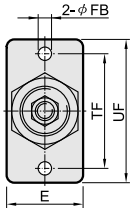

Bore φ 40

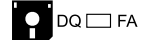
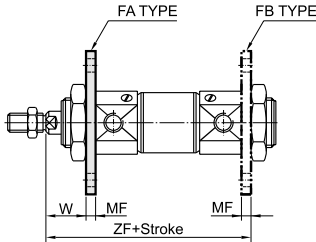
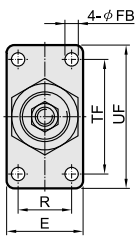

Dimensional Table

Type	Bore	E	FB	MF	R	TF	UF
FA-20	φ 20	34	7	4	-	60	75
FA-25	φ 25	40	7	4	-	60	75
FA-32	φ 32	40	7	4	-	60	75
FA-40	φ 40	52	7	5	36	66	82

Type	Bore	W	ZF
FA-20	φ 20	19	89
FA-25	φ 25	19	89
FA-32	φ 32	19	91
FA-40	φ 40	21	119

●LB TYPE

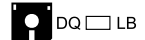
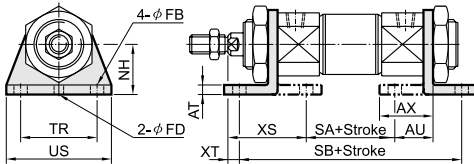

Dimensional Table

Type	Bore	AT	AU	AX	FB	FD	NH
LB-20	φ 20	3.2	20	28	7	4	25
LB-25	φ 25	3.2	20	28	7	4	28
LB-32	φ 32	3.2	20	28	7	4	28
LB-40	φ 40	3.2	23	33	7	4	30

Type	Bore	SA	SB	TR	US	XT	XS
LB-20	φ 20	28.4	102	40	55	3	39.8
LB-25	φ 25	28.4	102	40	55	3	39.8
LB-32	φ 32	30.4	104	40	55	3	39.8
LB-40	φ 40	48.4	134	55	75	3	45.8

●TA(FB) TYPE

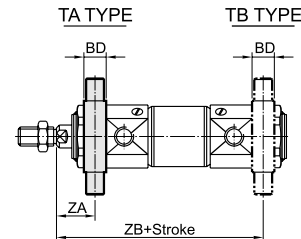
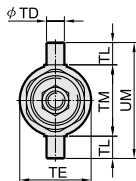

Dimensional Table

Type	Bore	BD	TD	TE	TL	TM	UM
TA-20	φ 20	10	8	32	10	32	52
TA-25	φ 25	10	9	40	10	40	60
TA-32	φ 32	10	9	40	10	40	60
TA-40	φ 40	11	10	53	12	53	77

Type	Bore	ZA	ZB
TA-20	φ 20	18	90
TA-25	φ 25	18	90
TA-32	φ 32	18	92
TA-40	φ 40	20.5	119.5

- DA
- DP
- DS
- DQ
- DB
- DN
- BN
- ST
- NT
- DU
- DJ
- TA
- GP
- GS
- GM
- GT
- RT
- CT
- CH

Mounting Dimension of Double Acting Cylinders (with end cushion)

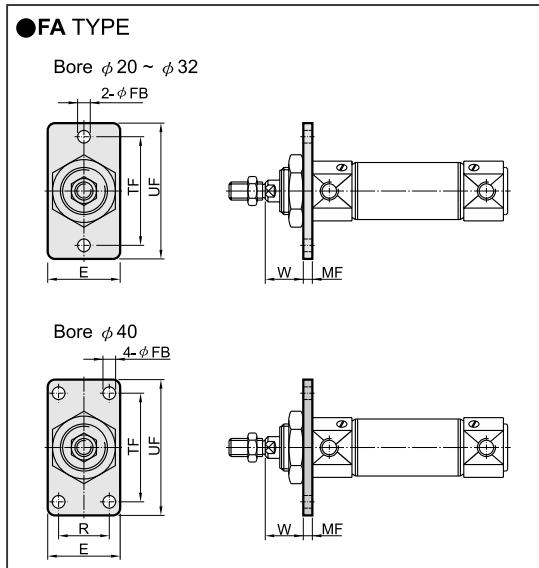

Dimensional Table



Type	Bore	E	FB	MF	R	TF
FA-20	φ 20	34	7	4	-	60
FA-25	φ 25	40	7	4	-	60
FA-32	φ 32	40	7	4	-	60
FA-40	φ 40	52	7	5	36	66

Type	Bore	UF	W
FA-20	φ 20	75	19
FA-25	φ 25	75	19
FA-32	φ 32	75	19
FA-40	φ 40	82	21

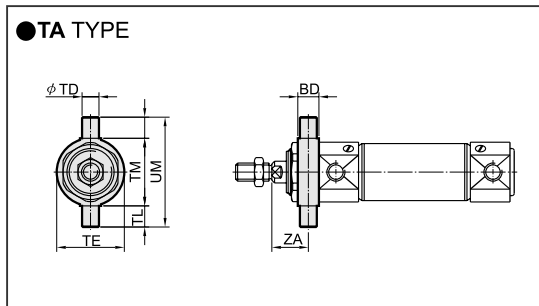

Dimensional Table



Type	Bore	BD	TD	TE	TL	TM
TA-20	φ 20	10	8	32	10	32
TA-25	φ 25	10	9	40	10	40
TA-32	φ 32	10	9	40	10	40
TA-40	φ 40	11	10	53	12	53

Type	Bore	UM	ZA
TA-20	φ 20	52	18
TA-25	φ 25	60	18
TA-32	φ 32	60	18
TA-40	φ 40	77	20.5



Mounting Dimension of Double Acting Cylinders (with end cushion)

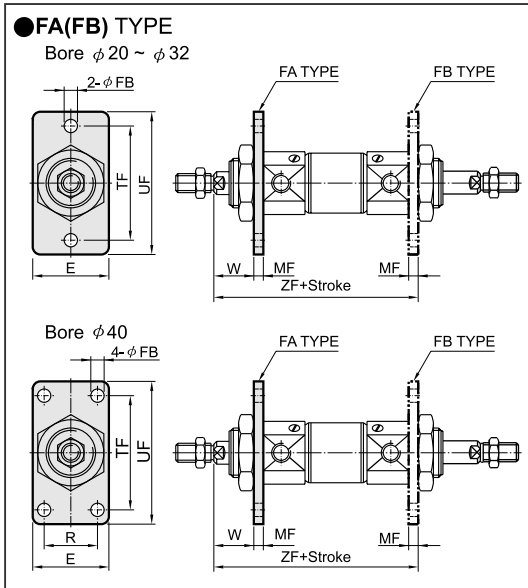

Dimensional Table

Type	Bore	E	FB	MF	R	TF	UF
FA-20	φ 20	34	7	4	-	60	75
FA-25	φ 25	40	7	4	-	60	75
FA-32	φ 32	40	7	4	-	60	75
FA-40	φ 40	52	7	5	36	66	82

Type	Bore	W	ZF
FA-20	φ 20	19	89
FA-25	φ 25	19	89
FA-32	φ 32	19	91
FA-40	φ 40	21	119

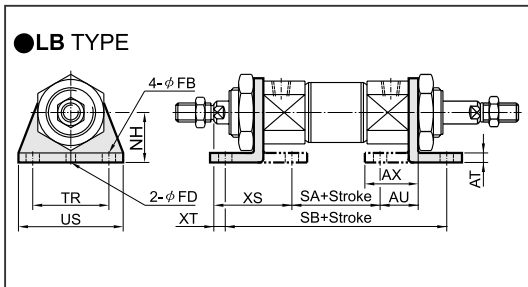

Dimensional Table

Type	Bore	AT	AU	AX	FB	FD	NH
LB-20	φ 20	3.2	20	28	7	4	25
LB-25	φ 25	3.2	20	28	7	4	28
LB-32	φ 32	3.2	20	28	7	4	28
LB-40	φ 40	3.2	23	33	7	4	30

Type	Bore	SA	SB	TR	US	XT	XS
LB-20	φ 20	28.4	102	40	55	3	39.8
LB-25	φ 25	28.4	102	40	55	3	39.8
LB-32	φ 32	30.4	104	40	55	3	39.8
LB-40	φ 40	48.4	134	55	75	3	45.8

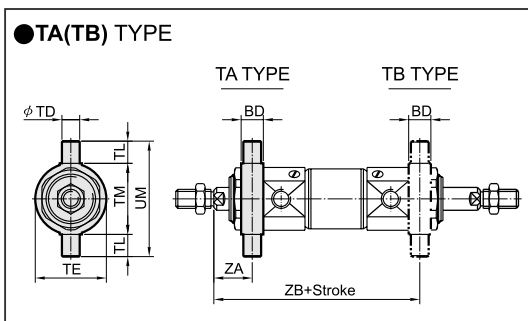

Dimensional Table

Type	Bore	BD	TD	TE	TL	TM	UM
TA-20	φ 20	10	8	32	10	32	52
TA-25	φ 25	10	9	40	10	40	60
TA-32	φ 32	10	9	40	10	40	60
TA-40	φ 40	11	10	53	12	53	77

Type	Bore	ZA	ZB
TA-20	φ 20	18	90
TA-25	φ 25	18	90
TA-32	φ 32	18	92
TA-40	φ 40	20.5	119.5

DA

DP

DS

DQ

DB

DN

BN

ST

NT

DU

DJ

TA

GP

GS

GM

GT

RT

CT

CH



Dimensional features

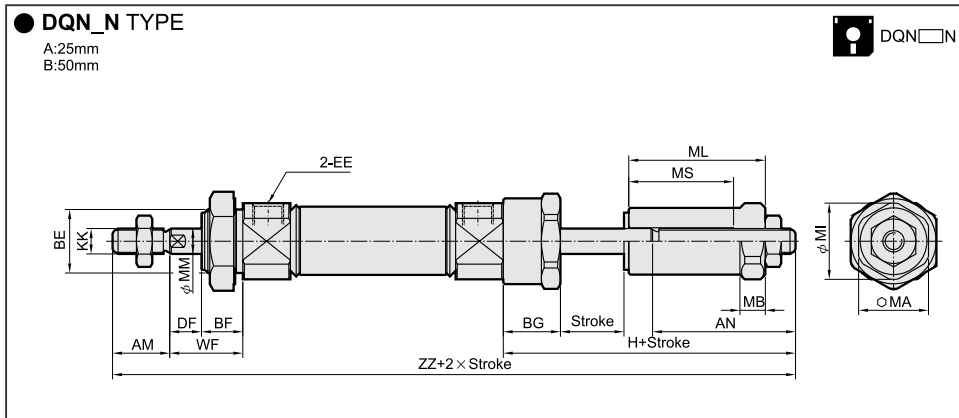

Dimensional Table

Bore	AN		AM	BE	BF	BG	DF	EE	H		KK	MA	MB	MI	ML		MM	MS		WF	ZZ	
	A	B							A	B					A	B		A	B		A	B
φ 20	44	69	18	M20×1.5P	13	18	10	G 1/8	71	96	M8×1.25P	22	8	24	43	68	8	33	58	23	174	199
φ 25	46	71	22	M26×1.5P	13	18	10	G 1/8	74	99	M10×1.25P	22	8	24	45	70	10	35	60	23	181	206
φ 32	49	74	22	M26×1.5P	13	18	10	G 1/8	77	102	M10×1.25P	27	10	29	47	72	12	35	60	23	186	211
φ 40	50	75	24	M32×2.0P	16	21	10	G 1/4	81	106	M14×1.5P	32	10	35	47	72	16	37	62	26	219	244

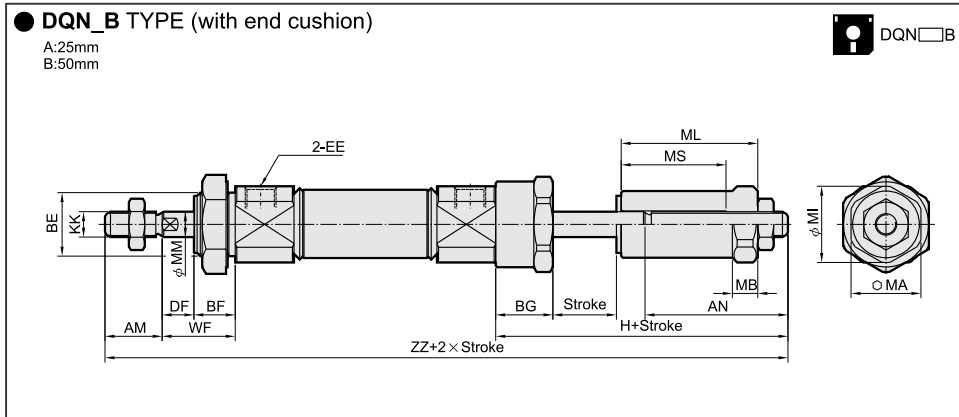

Dimensional Table

Bore	AN		AM	BE	BF	BG	DF	EE	H		KK	MA	MB	MI	ML		MM	MS		WF	ZZ	
	A	B							A	B					A	B		A	B		A	B
φ 20	44	69	18	M20×1.5P	13	18	10	G 1/8	71	96	M8×1.25P	22	8	24	43	68	8	33	58	23	174	199
φ 25	46	71	22	M26×1.5P	13	18	10	G 1/8	74	99	M10×1.25P	22	8	24	45	70	10	35	60	23	181	206
φ 32	49	74	22	M26×1.5P	13	18	10	G 1/8	77	102	M10×1.25P	27	10	29	47	72	12	35	60	23	186	211
φ 40	50	75	24	M32×2.0P	16	21	10	G 1/4	81	106	M14×1.5P	32	10	35	47	72	16	37	62	26	219	244



Installation of sensor switches

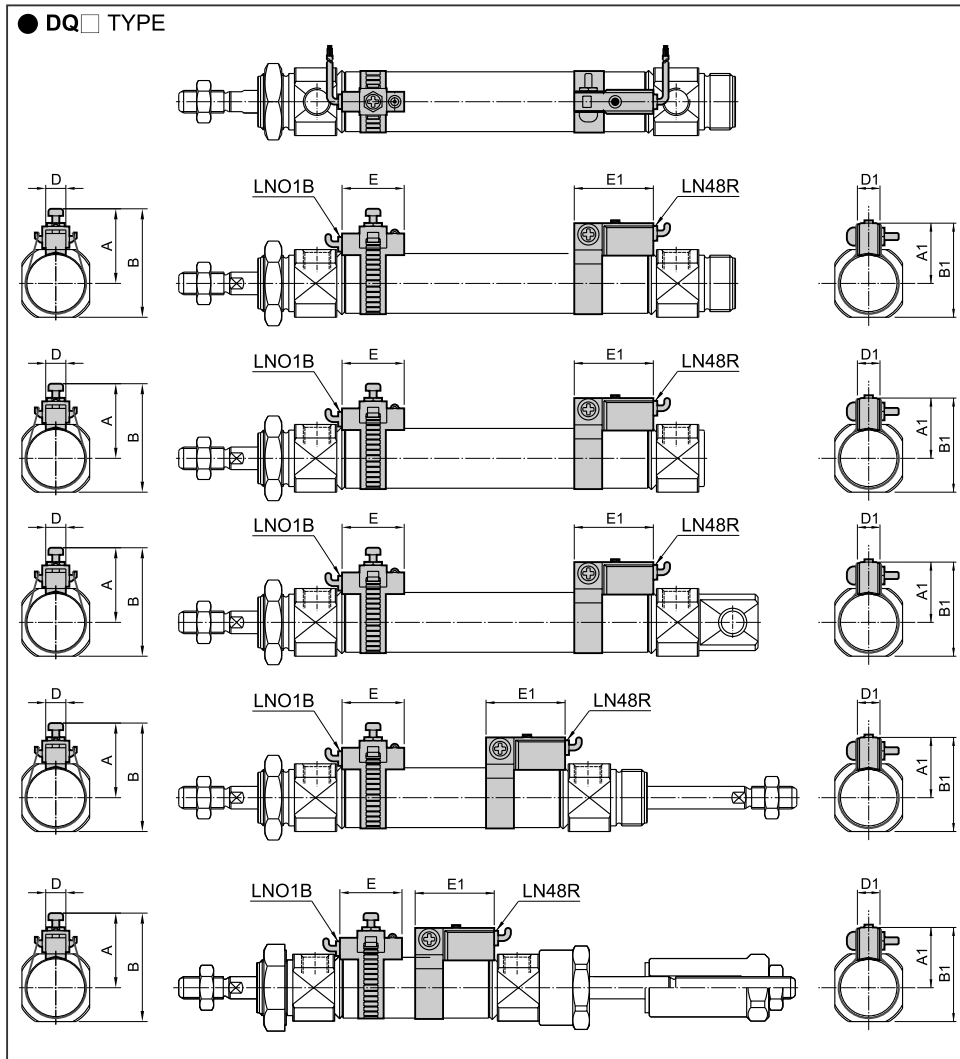

DA

DP

DS

DQ

DB

DN

BN

ST

NT

DU

DJ

TA

GP

GS

GM

GT

RT

CT

CH

Dimensional Table

Bore	Sensor switch	A	B	D	E
φ 20	LN01B	25.5	37.5	7	22
φ 25	LN01B	28.4	43.4	7	22
φ 32	LN01B	32	49.3	7	22
φ 40	LN01B	36.3	57	7	22

Bore	Sensor switch	Clamp NO.	A1	B1	D1	E1
φ 20	LN48R	BS-S20	22	34	8	28
φ 25	LN48R	BS-S25	24	39	8	28
φ 32	LN48R	BS-S32	28	45.5	8	28
φ 40	LN48R	BS-S40	32	53	8	28