

7MPa Double acting hydraulic cylinders

DMB

Double Acting - Standard Type



DMD

Double Acting - Double End Rod Type



DMN-A, DMN-B

Double Acting - Adjustable Forward Stroke Cylinder

A:25mm
B:50mm

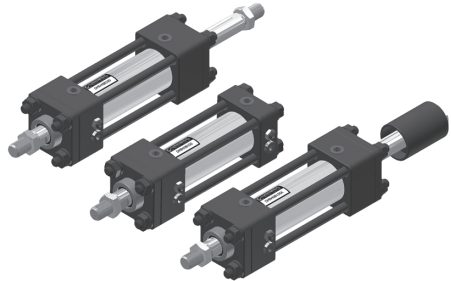

- Piston with magnet is standard accessory.
- Hydro-cylinders of this series can be added with cushions.

Specification

Bore sizes of cylinder (mm)	φ 40	φ 50	φ 63	φ 80	φ 100
Power fluid	Filtered oil				
Material of cylinder barrel	SUS304 Stainless steel				
The range of pressure (MPa)	7				
Proof pressure (MPa)	10.5				
The range of speed (mm/sec)	0.5~300				
The range of temperature (°C)	-10~+60				

How to order

2 DMN 50 B 100 (B C) - A LB - Y - LN01P × 2

Seal material	Type	Bore	Cushion	Stroke	Cushion adjustment location	Adjustable stroke	Accessory	Sensor switch	Quantity																												
 DMB DMD DMN	40—φ 40mm 50—φ 50mm 63—φ 63mm 80—φ 80mm 100—φ 100mm	R: Rod cover with cushion H: End cap with cushion B: Both end with cushion N: No cushion	50—50mm 100—100mm 150—150mm 200—200mm 250—250mm 300—300mm 350—350mm 400—400mm 450—450mm 500—500mm	None: standard A: Adjustable 25mm B: Adjustable 50mm Note: this number can only be used for the adjustable type.	 FA FB LA LB CA CB TC Y I	LN01P: Suited for φ 40, φ 50 LN02P: Suited for φ 63 LN03P: Suited for φ 80, φ 100 Note: 1. Can choose NPN or PNP type (3-Wire type, 24VDC). 2. Can choose plug-in cable. 3. For details see page 4-1,4.	1: 1pc 2: 2pcs																														
	※Cushion position adjustment: Ports Location B Cushion adjustment location C	Those without marks are in standard type, and its positions are described as followed. (A) Ports Location (B) Cushion adjustment location																																			
	<table border="1"> <thead> <tr> <th rowspan="2">Symbol</th> <th rowspan="2">Seal material</th> <th colspan="5">Kind of fluid</th> </tr> <tr> <th>Petroleum - Based fluid</th> <th>Water - Glycol fluid</th> <th>Phosphate - Ester fluid</th> <th>W/O Water in oil fluid</th> <th>O/W Oil in water fluid</th> </tr> </thead> <tbody> <tr> <td>1</td> <td>NBR</td> <td>○</td> <td>○</td> <td>×</td> <td>○</td> <td>○</td> </tr> <tr> <td>2</td> <td>PU</td> <td>○</td> <td>×</td> <td>×</td> <td>△</td> <td>△</td> </tr> <tr> <td>3</td> <td>VITON</td> <td>○</td> <td>×</td> <td>○</td> <td>○</td> <td>○</td> </tr> </tbody> </table>	Symbol	Seal material	Kind of fluid					Petroleum - Based fluid	Water - Glycol fluid	Phosphate - Ester fluid	W/O Water in oil fluid	O/W Oil in water fluid	1	NBR	○	○	×	○	○	2	PU	○	×	×	△	△	3	VITON	○	×	○	○	○			
Symbol	Seal material			Kind of fluid																																	
		Petroleum - Based fluid	Water - Glycol fluid	Phosphate - Ester fluid	W/O Water in oil fluid	O/W Oil in water fluid																															
1	NBR	○	○	×	○	○																															
2	PU	○	×	×	△	△																															
3	VITON	○	×	○	○	○																															

Note: ○: allowable ×: unallowable △: consult us

Standard stroke

Unit : mm

Bore	50	100	150	200	250	300	350	400	450	500
φ 40	●	●	●	●	●	●	-	-	-	-
φ 50	●	●	●	●	●	●	-	-	-	-
φ 63	●	●	●	●	●	●	●	●	●	●
φ 80	●	●	●	●	●	●	●	●	●	●
φ 100	●	●	●	●	●	●	●	●	●	●

Note: May to order of unstandard stroke

Stroke tolerance

Unit : mm

Stroke	~100	101~250	251~630	631~1000	1001~1600	1601~2000
Tolerance	+0.8 0	+1.0 0	+1.25 0	+1.4 0	+1.6 0	+1.8 0

Theoretic force

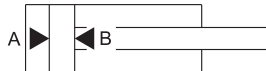

Unit : N

Bore (mm)	Rod (mm)	Pressure area (mm ²)	Operating pressure (MPa)									
			2	3	4	5	6	7	8	9	10	
φ 40	φ 20	A	1256	2512	3768	5024	6280	7536	8792	10048	11304	12560
		B	942	1884	2826	3768	4710	5652	6594	7536	8478	9420
φ 50	φ 25	A	1963	3926	5889	7852	9815	11778	13741	15704	17667	19630
		B	1472	2944	4416	5888	7360	8832	10304	11776	13248	14720
φ 63	φ 35	A	3116	6232	9348	12464	15580	18696	21812	24928	28062	31180
		B	2154	4308	6462	8616	10770	12924	15078	17232	19386	21540
φ 80	φ 40	A	5024	10048	15072	20096	25120	30144	35168	40192	45216	50240
		B	3768	7536	11304	15072	18840	22608	26376	30144	33912	37680
φ 100	φ 50	A	7850	15700	23550	31400	39250	47100	54950	62800	70650	78500
		B	5887	11774	17661	23548	29435	35322	41209	47096	52983	58870

The method of calculation (Hydraulic cylinders' force)

$$F = P \times A - f$$

F: Cylinders' force

(N)

P: Operating pressure

(MPa)

TC

TS

RP

HC

HC_M

HCK

TH

DO

DX

DW

DM

DH

DK

How to order the seal kit

DMBSK

Bore	Seal kit
40	DMBSK40 - Including No.13,14,15,16,17
50	DMBSK50 - Including No.13,14,15,16,17
63	DMBSK63 - Including No.13,14,15,16,17
80	DMBSK80 - Including No.13,14,15,16,17
100	DMBSK100 - Including No.13,14,15,16,17

DMDSK

Bore	Seal kit
40	DMDSK40 - Including No.10,11,12,13,14
50	DMDSK50 - Including No.10,11,12,13,14
63	DMDSK63 - Including No.10,11,12,13,14
80	DMDSK80 - Including No.10,11,12,13,14
100	DMDSK100 - Including No.10,11,12,13,14

● DMB TYPE

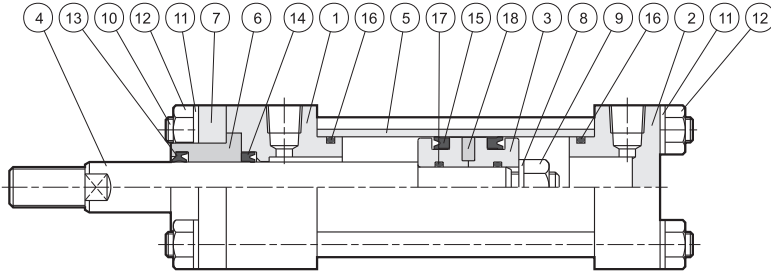

Parts List

No.	Part name	Quantity	No.	Part name	Quantity	No.	Part name	Quantity
1	Rod cover	1	7	End plate	1	13	Dust wiper	1
2	Head cover	1	8	Spring washer	1	14	Rod packing	1
3	Piston	1	9	Nut	1	15	Piston packing	2
4	Piston rod	1	10	Tie bolt	4	16	Cylinder gasket	2
5	Cylinder tube	1	11	Spring washer	8	17	Piston gasket	2
6	Rod bush	1	12	Nut	8	18	Magnet	1

● DMD TYPE

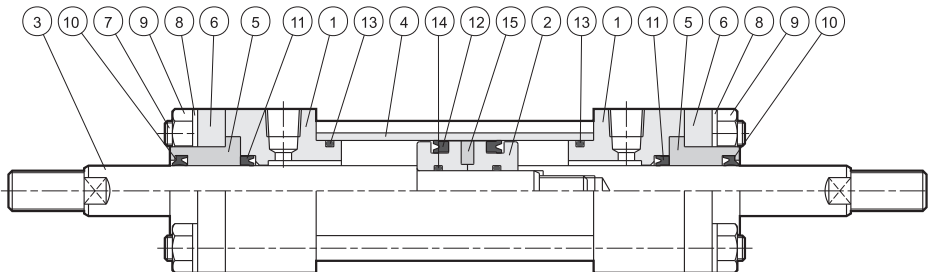

Parts List

No.	Part name	Quantity	No.	Part name	Quantity	No.	Part name	Quantity
1	Rod cover	2	6	End plate	2	11	Rod packing	2
2	Piston	1	7	Tie bolt	4	12	Piston packing	2
3	Piston rod	1	8	Spring washer	8	13	Cylinder gasket	2
4	Cylinder tube	1	9	Nut	8	14	Piston gasket	2
5	Rod bush	2	10	Dust wiper	2	15	Magnet	1

Dimensional features

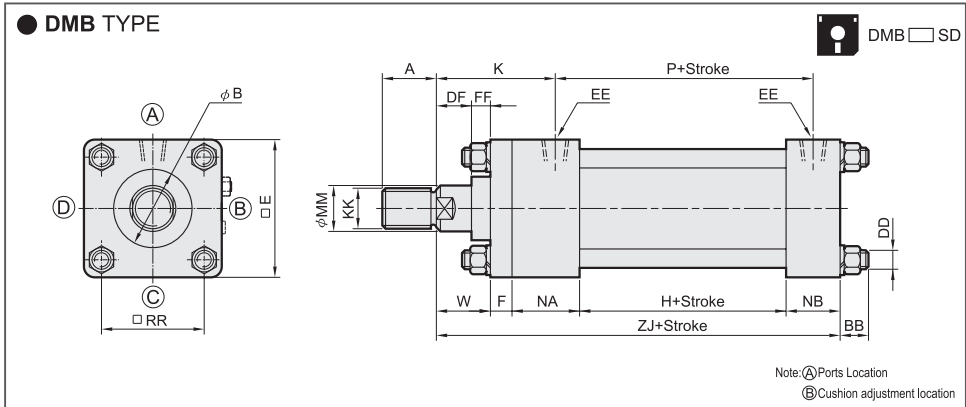

Dimensional Table

Bore	A	B	BB	DD	DF	E	EE	F	FF	H	K	KK	MM	NA	NB	P	RR	W	ZJ
φ 40	30	35	12	M10×1.25	14	65	PT 1/4	11	11	60	60	M16×1.5	20	36	26	84	45	25	158
φ 50	35	40	12	M10×1.25	16	75	PT 3/8	13	9	60	66	M22×1.5	25	42	34	88	52	25	174
φ 63	40	50	14	M12×1.5	21	90	PT 3/8	15	9	65	73	M30×1.5	35	42	34	93	63	30	186
φ 80	45	55	18	M16×1.5	23	110	PT 1/2	18	7	65	79	M30×1.5	40	46	39	95	80	30	198
φ 100	50	65	22	M18×1.5	33	135	PT 1/2	20	7	74	95	M40×2.0	50	50	40	104	102	40	224

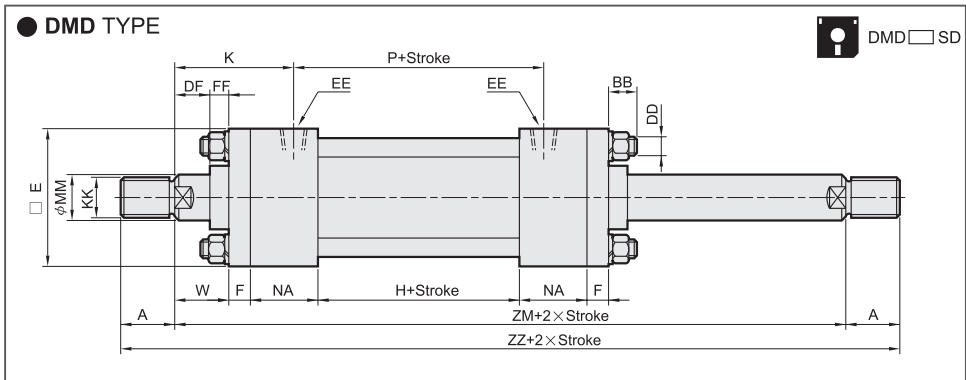

Dimensional Table

Bore	A	B	BB	DD	DF	E	EE	F	FF	H	K	KK	MM	NA	P	RR	W	ZM	ZZ
φ 40	30	35	12	M10×1.25	14	65	PT 1/4	11	11	60	60	M16×1.5	20	36	84	45	25	204	264
φ 50	35	40	12	M10×1.25	16	75	PT 3/8	13	9	60	66	M22×1.5	25	42	88	52	25	220	290
φ 63	40	50	14	M12×1.5	21	90	PT 3/8	15	9	65	73	M30×1.5	35	42	93	63	30	239	319
φ 80	45	55	18	M16×1.5	23	110	PT 1/2	18	7	65	79	M30×1.5	40	46	95	80	30	253	343
φ 100	50	65	22	M18×1.5	33	135	PT 1/2	20	7	74	95	M40×2.0	50	50	104	102	40	294	394

TC

TS

RP

HC

HC_M

HCK

TH

DO

DX

DW

DM

DH

DK

Dimensional features

● FA TYPE - Front Flange

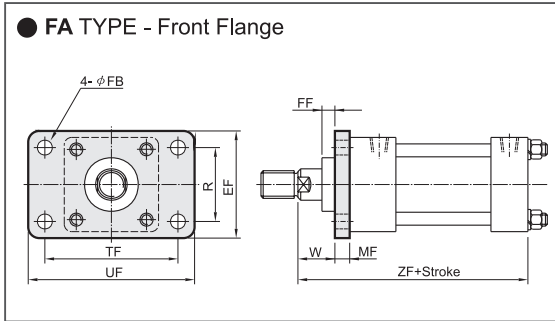

Dimensional Table



Bore	EF	FB	FF	MF	R	TF	UF	W	ZF
φ 40	69	11	11	11	46	95	118	25	158
φ 50	85	11	9	13	58	115	145	25	174
φ 63	98	14	9	15	65	132	165	30	186
φ 80	118	18	7	18	87	155	190	30	198
φ 100	150	22	7	20	109	190	230	40	224

● FB TYPE - Rear Flange

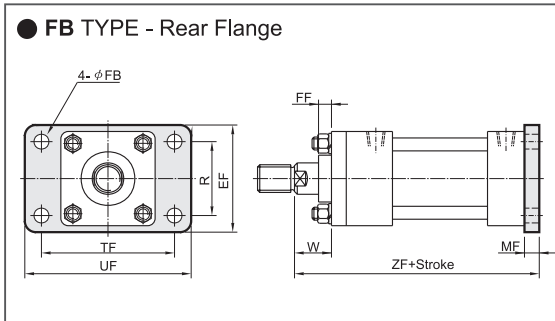

Dimensional Table



Bore	EF	FB	FF	MF	R	TF	UF	W	ZF
φ 40	69	11	11	11	46	95	118	25	169
φ 50	85	11	9	13	58	115	145	25	187
φ 63	98	14	9	15	65	132	165	30	201
φ 80	118	18	7	18	87	155	190	30	216
φ 100	150	22	7	20	109	190	230	40	244

● CA TYPE - Male Pivot

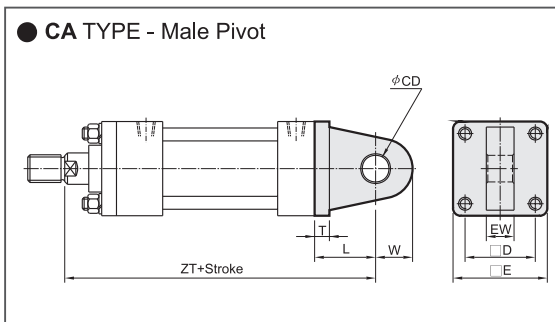

Dimensional Table



Bore	CD	D	E	EW	L	T	W	ZT
φ 40	16	45	65	20	38	11	16	196
φ 50	20	52	75	25	45	13	20	219
φ 63	25	63	90	30	54	15	25	240
φ 80	30	80	110	35	71	18	30	269
φ 100	40	102	135	40	86	20	40	310

● CB TYPE - Female Pivot

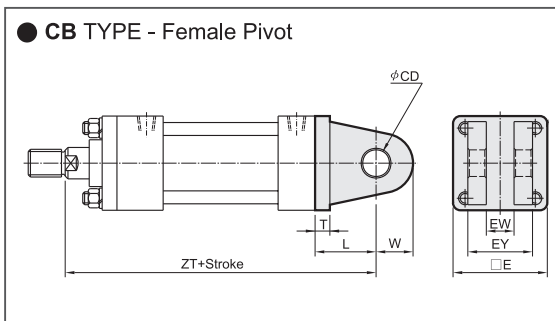

Dimensional Table



Bore	CD	E	EW	EY	L	T	W	ZT
φ 40	16	65	20	50	38	11	16	196
φ 50	20	75	25	57	45	13	20	219
φ 63	25	90	30	70	54	15	25	240
φ 80	30	110	35	80	71	18	30	269
φ 100	40	135	40	100	86	20	40	310

Dimensional features

● LA TYPE - Side lugs

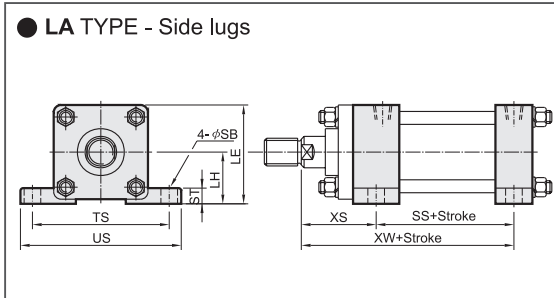

Dimensional Table



Bore	LE	LH	SB	SS	ST	TS	XS	XW	US
φ 40	70	37.5	11	91	14	95	54	145	118
φ 50	82.5	45	11	98	17	115	59	157	145
φ 63	95	50	14	103	19	132	66	169	165
φ 80	115	60	18	107.5	25	155	71	178.5	190
φ 100	138.5	71	22	119	27	190	85	204	230

TC

TS

RP

HC

HC_M

HCK

TH

DO

DX
DW

DM

DH

DK

● LB TYPE - Foot Mounting

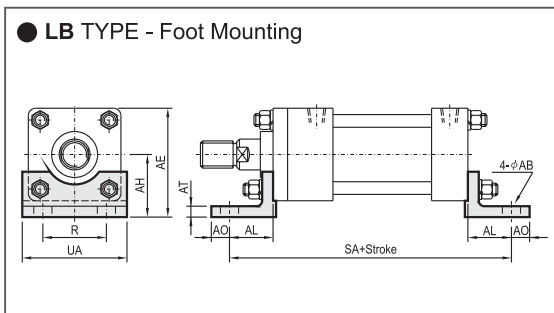

Dimensional Table



Bore	AB	AE	AH	AL	AO	AT	R	SA	UA
φ 40	11	75.5	43	32.5	13	8	46	198	69
φ 50	11	87.5	50	32.5	15	8	58	214	85
φ 63	14	105	60	37	18	10	65	230	98
φ 80	18	127	72	49	20	12	87	266	118
φ 100	22	152.5	85	58	23	12	109	300	150

● TC TYPE - Intermediate Pivot

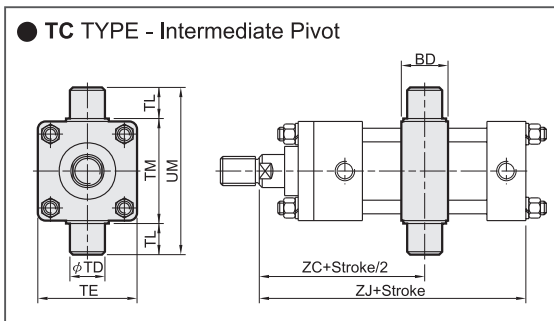

Dimensional Table



Bore	BD	TE	TD	TL	TM	UM	ZC	ZJ
φ 40	28	65	20	20	69	109	102	158
φ 50	33	75	25	25	85	135	110	174
φ 63	38	90	30	30	98	158	119.5	186
φ 80	38	110	30	30	118	178	126.5	198
φ 100	48	135	40	40	145	225	147	224

Accessories

● Y Rod Clevis

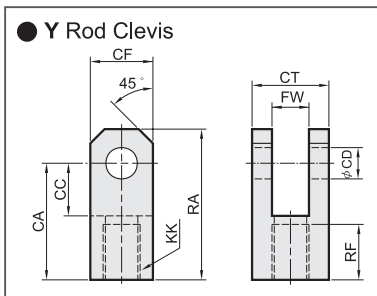

Dimensional Table



Type	Bore	CA	CC	CD	CF	CT	FW	KK	RA	RF	Filename
Y-M16 × 1.5	φ 40	50	26	16	35	45	20	M16 × 1.5	66	24	YM16150H
Y-M22 × 1.5	φ 50	60	30	20	40	50	25	M22 × 1.5	80	30	YM22150H
Y-M30 × 1.5	φ 63	80	40	25	50	60	30	M30 × 1.5	105	40	YM30150M
Y-M30 × 1.5	φ 80	80	40	30	60	65	35	M30 × 1.5	110	40	YM30150H
Y-M40 × 2.0	φ 100	90	50	40	80	90	40	M40 × 2.0	130	40	YM40200H

Dimensional features

● FA TYPE - Front Flange

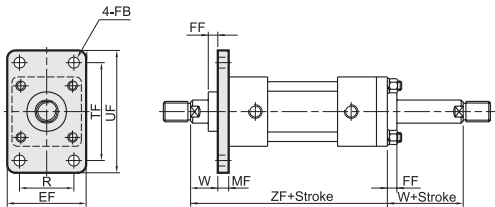

Dimensional Table



Bore	EF	FB	FF	MF	R	TF	UF	W	ZF
φ 40	69	11	11	11	46	95	118	25	179
φ 50	85	11	9	13	58	115	145	25	195
φ 63	98	14	9	15	65	132	165	30	209
φ 80	118	18	7	18	87	155	190	30	223
φ 100	150	22	7	20	109	190	230	40	254

● LA TYPE - Side lugs

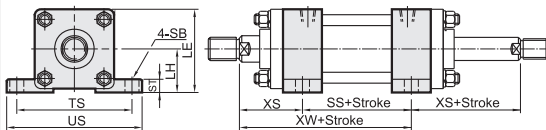

Dimensional Table



Bore	LE	LH	SB	SS	ST	TS	XS	XW	US
φ 40	70	37.5	11	96	14	95	54	150	118
φ 50	82.5	45	11	102	17	115	59	161	145
φ 63	95	50	14	107	19	132	66	173	165
φ 80	115	60	18	111	25	155	71	182	190
φ 100	138.5	71	22	124	27	190	85	209	230

● LB TYPE - Foot Mounting

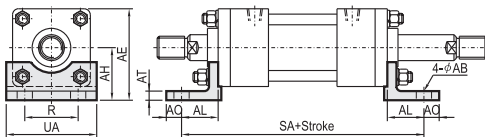

Dimensional Table



Bore	AB	AE	AH	AL	AO	AT	R	SA	UA
φ 40	11	75.5	43	32.5	13	8	46	219	69
φ 50	11	87.5	50	32.5	15	8	58	235	85
φ 63	14	105	60	37	18	10	65	253	98
φ 80	18	127	72	49	20	12	87	291	118
φ 100	22	152.5	85	58	23	12	109	330	150

● TC TYPE - Intermediate Pivot

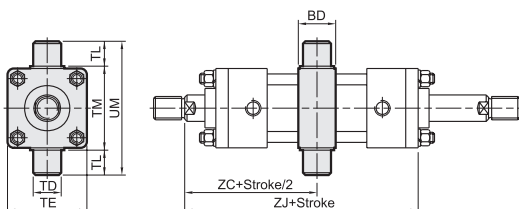

Dimensional Table



Bore	BD	TE	TD	TL	TM	UM	ZC	ZJ
φ 40	28	65	20	20	69	109	102	179
φ 50	33	75	25	25	85	135	110	195
φ 63	38	90	30	30	98	158	119.5	209
φ 80	38	110	30	30	118	178	126.5	223
φ 100	48	135	40	40	145	225	147	254

Accessories

● Pin

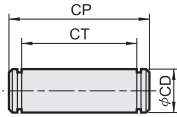

Dimensional Table

Type	Bore	CD		CP		CT		Filename
		Y-PIN	CB-PIN	Y-PIN	CB-PIN	Y-PIN	CB-PIN	
P1659	φ 40	16	16	59	64	46	51	P16059
P2066	φ 50	20	20	66	73	51	58	P20066
P2576	φ 63	25	25	76	86	61	71	P25076
P3081	φ 80	30	30	81	96	66	81	P30081
P40114	φ 100	40	40	114	124	91	101	P40114

● I Rod end mounting

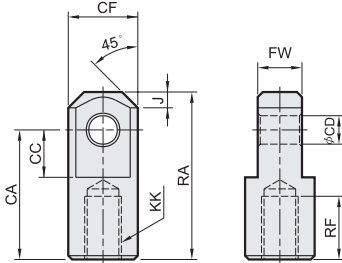

Dimensional Table

Type	Bore	CA	CC	CD	CF	FW	J	KK	RA	RF	Filename
I-M16x1.5	φ 40	55	30	16	40	20	8	M16x1.5	75	20	IM16150H
I-M22x1.5	φ 50	65	35	20	50	25	10	M22x1.5	90	25	IM22150H
I-M30x1.5	φ 63	80	40	25	55	30	12.5	M30x1.5	110	35	IM30150M
I-M30x1.5	φ 80	90	45	30	60	35	15	M30x1.5	125	35	IM30150H
I-M40x2.0	φ 100	105	55	40	80	40	20	M40x2.0	145	40	IM40200H

● Mounting Nut

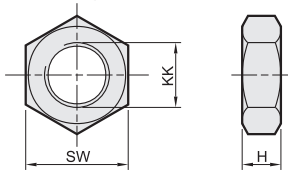

Dimensional Table

Type	Bore	H	KK	SW	Filename
N-M16x1.5	φ 40	8	M16x1.5	24	NM16150
N-M22x1.5	φ 50	11	M22x1.5	32	NM22150H
N-M30x1.5	φ 63	13	M30x1.5	41	NM30150H
N-M30x1.5	φ 80	13	M30x1.5	41	NM30150H
N-M40x2.0	φ 100	15	M40x2.0	57	NM40200H

Installation of sensor switches

● DM TYPE

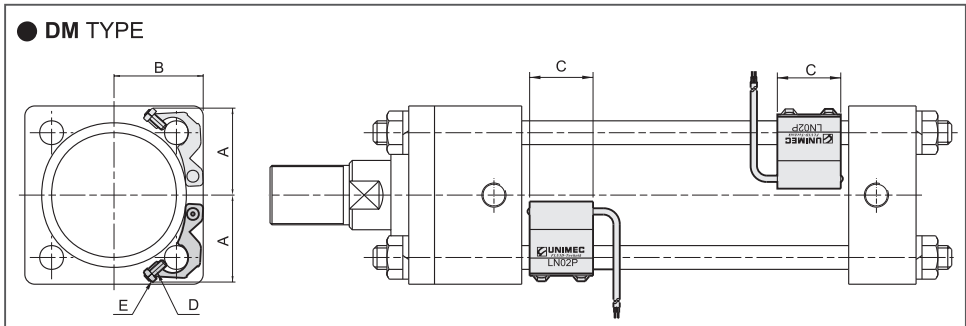

Dimensional Table

Bore	Sensor switch	A	B	C	D	E
φ 40	LN01P	33.7	33	32	M4x12L	M4
φ 50	LN01P	36.6	37	32	M4x12L	M4
φ 63	LN02P	44	45	32	M4x12L	M4
φ 80	LN03P	54	56	32	M4x12L	M4
φ 100	LN03P	65	67	32	M4x12L	M4

TC

TS

RP

HC

HC_M

HCK

TH

DO

DX
DW

DM

DH

DK

Dimensional features

● DMN_A TYPE Adjustable stroke 25mm

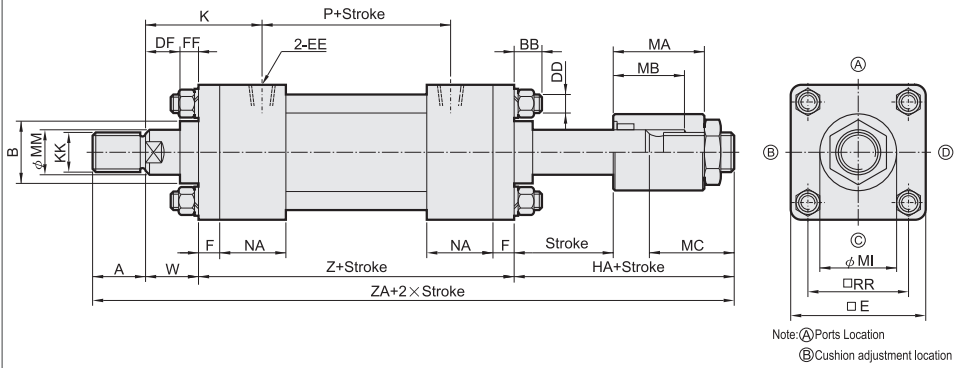

Dimensional Table

Bore	A	B	BB	DD	DF	E	EE	F	FF	HA	K	KK	MA	MB	MC	MI	MM	NA	P	RR	W	Z	ZA
φ 40	30	35	12	M10 × 1,25	14	65	PT1/4	11	11	71	59	M16 × 1,5	60	45	51	42	20	36	86	45	25	154	280
φ 50	35	40	12	M10 × 1,25	16	75	PT3/8	13	9	77	65	M22 × 1,5	63	45	57	50	25	42	90	52	25	170	307
φ 63	40	50	14	M12 × 1,5	21	90	PT3/8	15	9	81	72	M30 × 1,5	65	45	61	60	35	42	95	63	30	179	330
φ 80	45	55	18	M16 × 1,5	23	110	PT1/2	18	7	81	76	M30 × 1,5	65	45	61	70	40	46	101	80	30	193	349
φ 100	50	65	22	M18 × 1,5	33	135	PT1/2	20	7	88	92	M40 × 2,0	70	45	68	80	50	50	110	102	40	214	392

● DMN_B TYPE Adjustable stroke 50mm

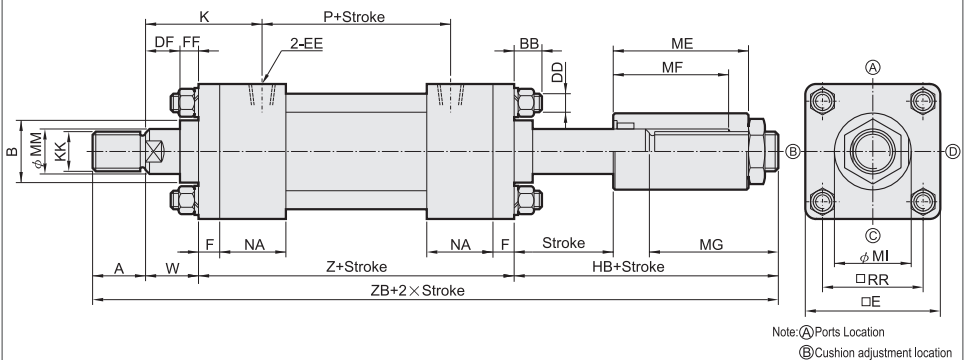

Dimensional Table

Bore	A	B	BB	DD	DF	E	EE	F	FF	HB	K	KK	ME	MF	MG	MI	MM	NA	P	RR	W	Z	ZB
φ 40	30	35	12	M10 × 1,25	14	65	PT1/4	11	11	96	59	M16 × 1,5	85	70	76	42	20	36	86	45	25	154	305
φ 50	35	40	12	M10 × 1,25	16	75	PT3/8	13	9	102	65	M22 × 1,5	88	70	82	50	25	42	90	52	25	170	332
φ 63	40	50	14	M12 × 1,5	21	90	PT3/8	15	9	106	72	M30 × 1,5	90	70	86	60	35	42	95	63	30	179	355
φ 80	45	55	18	M16 × 1,5	23	110	PT1/2	18	7	106	76	M30 × 1,5	90	70	86	70	40	46	101	80	30	193	374
φ 100	50	65	22	M18 × 1,5	33	135	PT1/2	20	7	113	92	M40 × 2,0	95	70	93	80	50	50	110	102	40	214	417

Dimensional features

Adjustable stroke 25mm

●FA TYPE - Front Flange

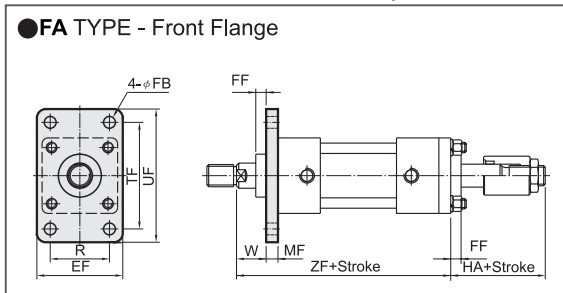

Dimensional Table DMN □ N_A-FA

Bore	EF	FB	FF	HA	MF	R	TF	UF	W	ZF
φ 40	69	11	11	71	11	46	95	118	25	179
φ 50	85	11	9	77	13	58	115	145	25	195
φ 63	98	14	9	81	15	65	132	165	30	209
φ 80	118	18	7	81	18	87	155	190	30	223
φ 100	150	22	7	88	20	109	190	230	40	254

TC

TS

RP

HC

HC_M

HCK

TH

DO

DX

DW

DM

DH

DK

●LA TYPE - Side lugs

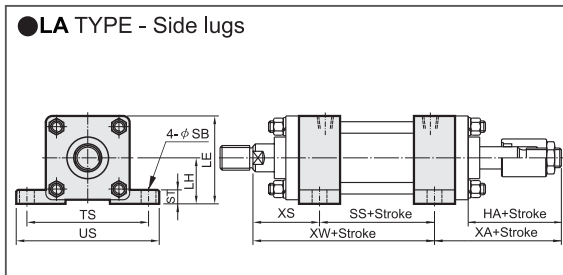

Dimensional Table DMN □ N_A-LA

Bore	LE	LH	HA	SB	SS	ST	TS	XA	XS	XW	US
φ 40	70	37.5	71	11	96	14	95	100	54	150	118
φ 50	82.5	45	77	11	102	17	115	111	59	161	145
φ 63	95	50	81	14	107	19	132	117	66	173	165
φ 80	115	60	81	18	111	25	155	122	71	182	190
φ 100	138.5	71	88	22	124	27	190	133	85	209	230

●LB TYPE - Foot Mounting

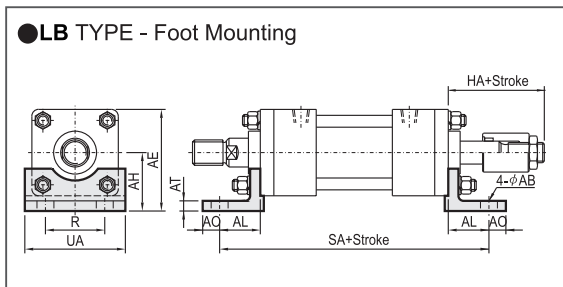

Dimensional Table DMN □ N_A-LB

Bore	AB	AE	AH	AL	AO	AT	HA	R	SA	UA
φ 40	11	75.5	43	32.5	13	8	71	46	219	69
φ 50	11	87.5	50	32.5	15	8	77	58	235	85
φ 63	14	105	60	37	18	10	81	65	253	98
φ 80	18	127	72	49	20	12	81	87	291	118
φ 100	22	152.5	85	58	23	12	88	109	330	150

●TC TYPE - Intermediate Pivot

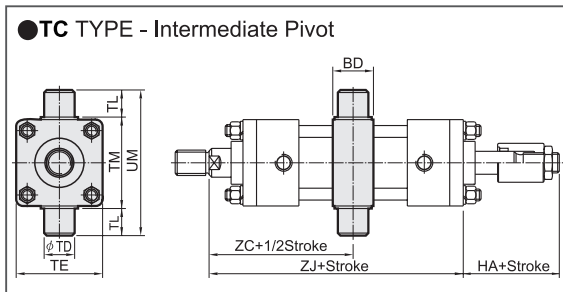

Dimensional Table DMN □ N_A-TC

Bore	BD	TE	TD	TL	TM	HA	UM	ZC	ZJ
φ 40	28	65	20	20	69	71	109	102	179
φ 50	33	75	25	25	85	77	135	110	195
φ 63	38	90	30	30	98	81	158	119.5	209
φ 80	38	110	30	30	118	81	178	126.5	223
φ 100	48	135	40	40	145	88	225	147	254

Dimensional features

Adjustable stroke 50mm

●FA TYPE - Front Flange

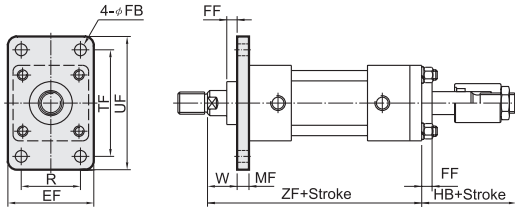

Dimensional Table DMN □ N_B-FA

Bore	EF	FB	FF	HB	MF	R	TF	UF	W	ZF
φ 40	69	11	11	96	11	46	95	118	25	179
φ 50	85	11	9	102	13	58	115	145	25	195
φ 63	98	14	9	106	15	65	132	165	30	209
φ 80	118	18	7	106	18	87	155	190	30	223
φ 100	150	22	7	113	20	109	190	230	40	254

●LA TYPE - Side lugs

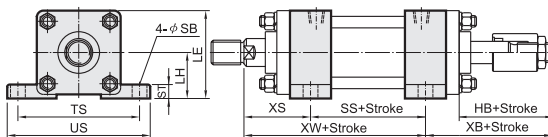

Dimensional Table DMN □ N_B-LA

Bore	LE	LH	HB	SB	SS	ST	TS	XB	XS	XW	US
φ 40	70	37.5	96	11	96	14	95	125	54	150	118
φ 50	82.5	45	102	11	102	17	115	136	59	161	145
φ 63	95	50	106	14	107	19	132	142	66	173	165
φ 80	115	60	106	18	111	25	155	147	71	182	190
φ 100	138.5	71	113	22	124	27	190	158	85	209	230

●LB TYPE - Foot Mounting

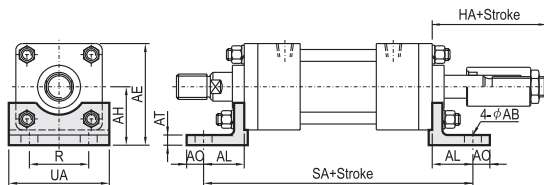

Dimensional Table DMN □ NA_B-LB

Bore	AB	AE	AH	AL	AO	AT	HB	R	SA	UA
φ 40	11	75.5	43	32.5	13	8	96	46	219	69
φ 50	11	87.5	50	32.5	15	8	102	58	235	85
φ 63	14	105	60	37	18	10	106	65	253	98
φ 80	18	127	72	49	20	12	106	87	291	118
φ 100	22	152.5	85	58	23	12	113	109	330	150

●TC TYPE - Intermediate Pivot

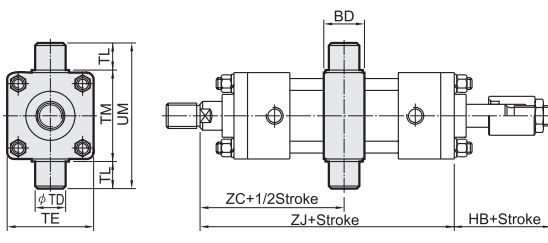



Dimensional Table DMN □ N_B-TC

Bore	BD	TE	TD	TL	TM	HB	UM	ZC	ZJ
φ 40	28	65	20	20	69	96	109	102	179
φ 50	33	75	25	25	85	102	135	110	195
φ 63	38	90	30	30	98	106	158	119.5	209
φ 80	38	110	30	30	118	106	178	126.5	223
φ 100	48	135	40	40	145	113	225	147	254



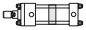

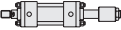
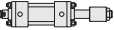
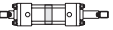



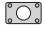

Cylinder weight (including the mounting nut)

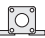
Unit: kg

Bore	Basic weight DHB TYPE	Stroke 25 mm DHB TYPE	Basic weight DHD TYPE	Basic weight DHN A TYPE	Basic weight DHN B TYPE	Stroke 25 mm DHD/DHN TYPE
						
φ 40	3.66	0.14	4.8	5.5	5.8	0.21
φ 50	6.15	0.22	8.0	9.1	9.5	0.32
φ 63	8.7	0.34	11	12.6	13.2	0.53
φ 80	14.6	0.54	17.3	19.5	20.3	0.80
φ 100	23.8	0.75	27.8	30.9	32	1.14

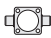
Mounting weight

Unit: kg

Bore	FA FB		LA	LB	CA	CB+pin	TC	Y+pin	I	Nut (Rod)
										
φ 40	0.3	0.6	0.5	0.6	0.6	0.7	0.6	0.6	0.6	0.02
φ 50	0.8	1.2	0.9	0.8	1.0	1.1	1.0	0.9	0.9	0.04
φ 63	1.3	1.8	1.0	1.4	1.8	2.1	1.2	1.5	1.2	0.08
φ 80	1.4	2.7	1.6	1.8	3.0	3.6	2.1	1.8	1.8	0.08
φ 100	2.2	4.8	1.9	3.0	5.1	6.6	3.8	4.2	3.3	0.18

Seating torque

Bore	φ 40, 50	φ 63	φ 80	φ 100
Bolt nut type	M10×1.25P	M12×1.5P	M16×1.5P	M18×1.5P
Seating torque (N · m)	42	56	120	160

TC

TS

RP

HC

HC_M

HCK

TH

DO

DX
DW

DM

DH

DK