

Aluminium Alloy Body Air Cylinders

DACI · DAAI Single Acting - Normally Retracted Piston Rod Type	
DACO · DAAO Single Acting - Normally Extended Piston Rod Type	
DAC · DAA Double Acting - Single End Rod Type	
DAD Double Acting - Double End Rod Type	
DAN...A · DAN...B Double End Rod Type - Adjustable	 A:25mm B:50mm



- Piston with magnet is standard accessory in the DA series cylinders.
- The rod cover and End cap, molded by rolling and riveting, are of high concentricity and stability.
- The cylinder tube, made of aluminium alloy, has effective thermal cooling in high-frequency operation.

Specification

Bore sizes of cylinder (mm)	φ 20	φ 30	φ 40
Stroke (Single acting) (mm)	15, 25, 50, 75, 100		
Stroke (Double acting) (mm)	25, 50, 75, 100, 125, 150, 175, 200, 250, 300		
The range of stroke (mm)	300	500	
The range of adjustable stroke (mm)	Max. 100		
Power fluid	Filtered air with or without lubrication		
Material of cylinder barrel	Anodised aluminium alloy		
The range of pressure (MPa)	Double Acting:1.03 Single Acting:0.23~1.03		
The range of temperature (°C)	-10~+60		

How to order

DAN	30	100	A	LB	Y	LN-01G	2
Type	Bore	Stroke	Adjustable stroke	Accessory		Sensor switch	Quantity
 DAA	20—φ 20mm 30—φ 30mm 40—φ 40mm	15—15mm 25—25mm 50—50mm 75—75mm 100—100mm 125—125mm 150—150mm 175—175mm 200—200mm 250—250mm 300—300mm 500—500mm	None: standard A: Adjustable 25mm B: Adjustable 50mm Note: this number can only be used for the adjustable type.	 FA	 FB	 LN-01G	1: 1pc 2: 2pcs
 DAC				 LB	 CU	 LN-48G	
 DAD	 DAN			 Y	 I	Note: 1.Can choose NPN or PNP type (3-Wire type, 24VDC), 2.Can choose plug-in cable.	
 DAAI	 DAAO			 G	 K		
 DACI	 DACO						

Dimensional features of double acting cylinders

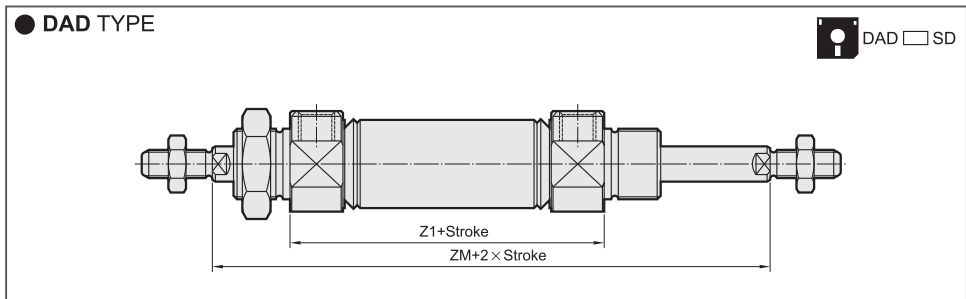
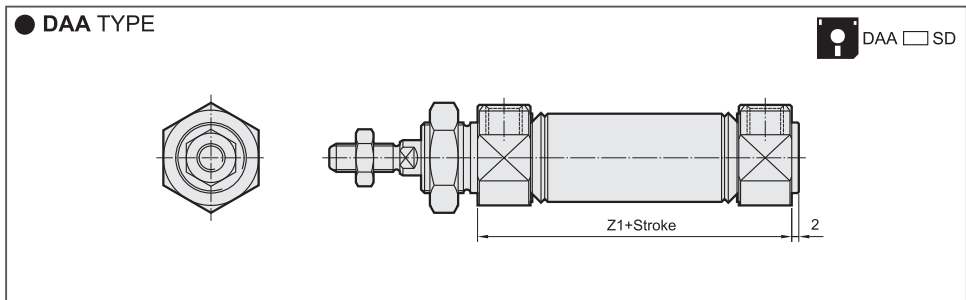
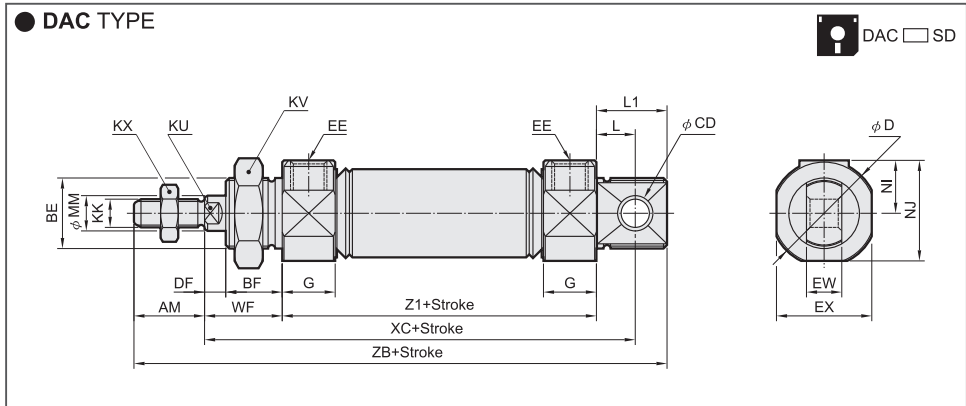

- DA
- DP
- DS
- DQ
- DB
- DN
- BN
- ST
- NT
- DU
- DJ
- TA
- GP
- GS
- GM
- GT
- RT
- CT
- CH

Dimensional Table

Bore	AM	BE	BF	CD	D	DF	EE	EX	EW	G	KK	KU	KV	KX	L	L1	MM	NI	NJ	WF	XC	Z1	ZB	ZM
φ 20	20	M20×1.5	16	8	30	6	G 1/8	27	10	15	M8×1.25	8	27	14	11	20	10	15	28.5	22	97	64	126	108
φ 30	20	M26×1.5	18	10	38	8	G 1/8	35	12	16	M10×1.25	10	32	17	15	25	12	19	36.5	26	114	73	144	125
φ 40	23	M33×2.0	20	10	46	8	G 1/4	-	20	21.5	M14×1.5	14	41	22	15	27	16	-	-	28	129	86	164	142

Dimensional features

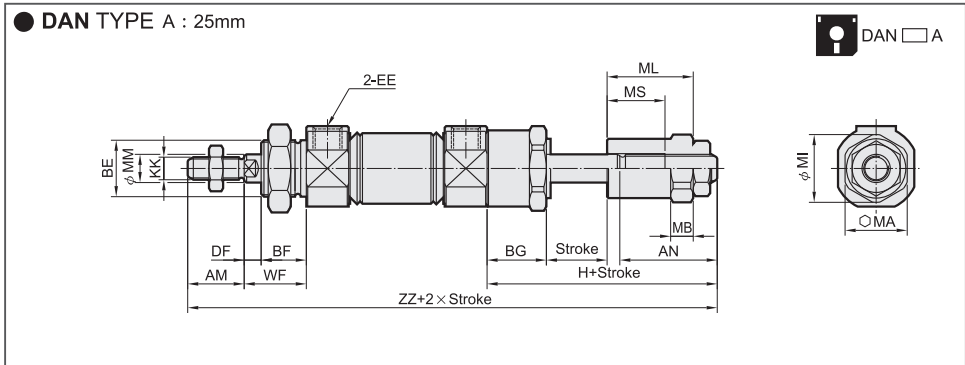

Dimensional Table

Bore	AN	AM	BE	BF	BG	DF	EE	H	KK	MA	MB	MI	ML	MM	MS	WF	ZZ
φ 20	49	20	M20 × 1.5	16	21	6	G 1/8	76	M8 × 1.25	22	8	24	45	10	35	22	182
φ 30	50	20	M26 × 1.5	18	23	8	G 1/8	81	M10 × 1.25	27	10	29	47	12	35	26	200
φ 40	52	23	M33 × 2.0	20	25	8	G 1/4	85	M14 × 1.5	32	10	35	47	16	37	28	222

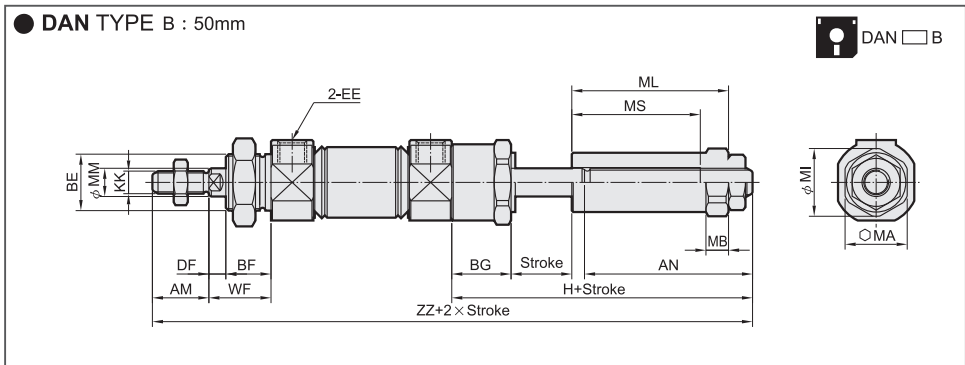

Dimensional Table

Bore	AN	AM	BE	BF	BG	DF	EE	H	KK	MA	MB	MI	ML	MM	MS	WF	ZZ
φ 20	74	20	M20 × 1.5	16	21	6	G 1/8	101	M8 × 1.25	22	8	24	70	10	60	22	207
φ 30	75	20	M26 × 1.5	18	23	8	G 1/8	106	M10 × 1.25	27	10	29	72	12	60	26	225
φ 40	77	23	M33 × 2.0	20	25	8	G 1/4	110	M14 × 1.5	32	10	35	72	16	62	28	247

Mounting Dimension of Double Acting Cylinders

● FB(FA) TYPE

Bore φ 20, φ 30

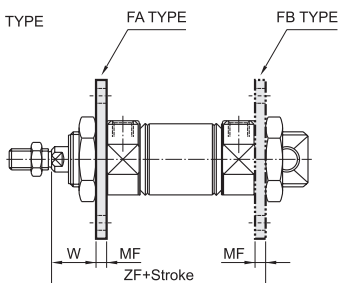
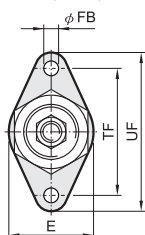

Bore φ 40

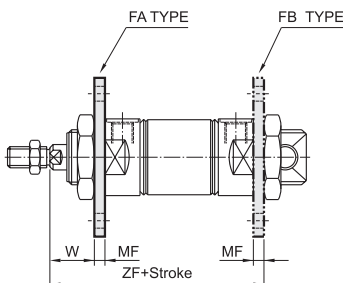
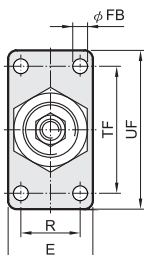

● LB TYPE

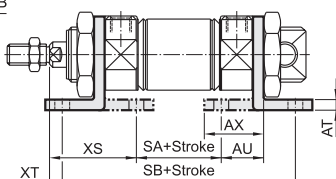
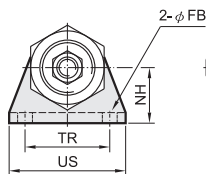

● CU TYPE

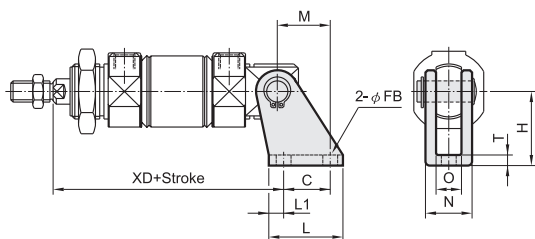

Dimensional Table



Type	Bore	E	FB	MF	R	TF	UF
FA-20	φ 20	40	7	5	-	60	75
FA-30	φ 30	40	7	5	-	60	75
FA-40	φ 40	50	9	5	30	80	100

Type	Bore	W	ZF
FA-20	φ 20	17	91
FA-30	φ 30	21	104
FA-40	φ 40	23.5	118.5

Dimensional Table



Type	Bore	AT	AU	AX	FB	NH	SA
LB-20	φ 20	5	20	28	7	23	34
LB-30	φ 30	5	20	28	7	26	43
LB-40	φ 40	5	20	30	9	40	56

Type	Bore	SB	TR	US	XT	XS
LB-20	φ 20	104	40	55	2	37
LB-30	φ 30	113	40	55	6	41
LB-40	φ 40	126	50	75	8	43

Dimensional Table



Type	Bore	C	FB	H	L	L1	M
CU-20	φ 20	20	7	30	32	6	16
CU-30	φ 30	25	7	40	40	7.5	20
CU-40	φ 40	25	9	40	40	7.5	20

Type	Bore	N	O	T	XD
CU-20	φ 20	24	16	4	93
CU-30	φ 30	28	20	4	109
CU-40	φ 40	28	20	4	124

DA

DP

DS

DQ

DB

DN

BN

ST

NT

DU

DJ

TA

GP

GS

GM

GT

RT

CT

CH

Dimensional features

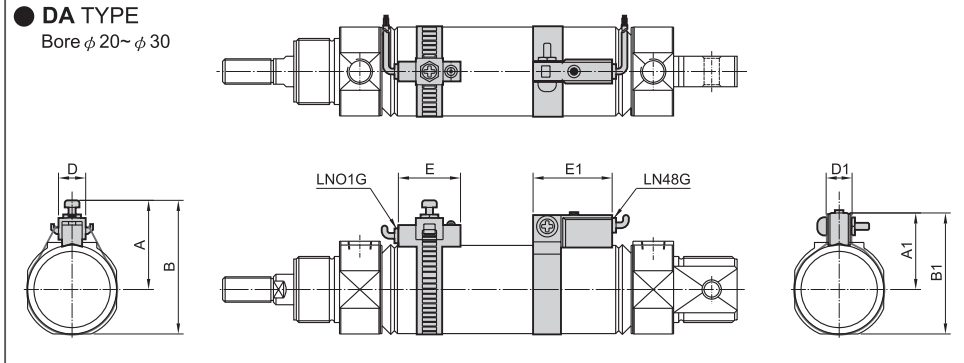

Dimensional Table

Bore	Sensor switch	A	B	D	E	Bore	Sensor switch	Clamp NO.	A1	B1	D1	E1
φ 20	LN01G	28	40.5	7	22	φ 20	LN48G	BS-A20	22	34.5	8	28
φ 30	LN01G	33	50.5	7	22	φ 30	LN48G	BS-A30	27	44.5	8	28
φ 40	LN01G	38	60.5	7	22	φ 40	LN48G	BS-A40	32	54.5	8	28

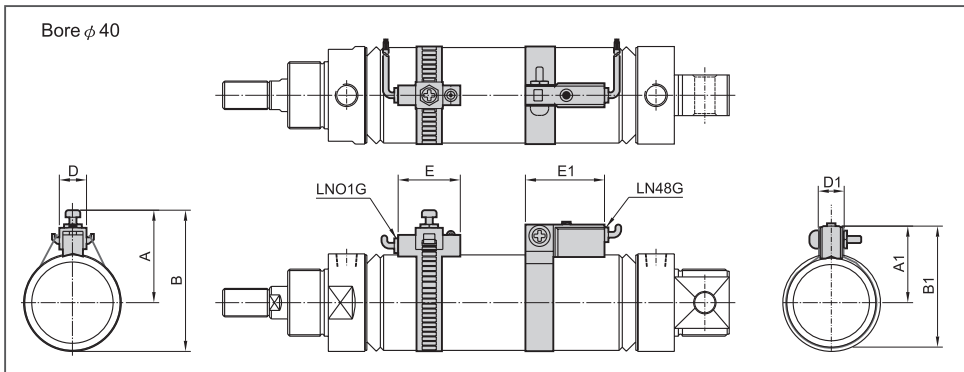

Cylinder Weight (Including The Mounting Nut)

Unit: kg

Bore	Basic weight	Stroke 25 mm	Basic weight	Stroke 25 mm	Basic weight	Stroke 25 mm	Sensor switch	
	DAC	DAC	DAA	DAA	DAD	DAD	LN01G	LN48G
φ 20	0.137	0.028	0.131	0.028	0.180	0.043	0.030	0.030
φ 30	0.337	0.040	0.323	0.040	0.401	0.062	0.030	0.030
φ 40	0.590	0.072	0.550	0.072	0.720	0.112	0.030	0.030

Mounting weight

Unit: kg

Bore	FA	FB	LB	CU	Y	I	G	K	Nut(Rod)	Nut(Cover)
	φ 20	0.052	0.169	0.064	0.046	0.044	0.053	0.061	0.005	0.020
φ 30	0.061	0.173	0.089	0.088	0.080	0.080	0.113	0.008	0.022	
φ 40	0.132	0.315	0.090	0.151	0.157	0.175	0.245	0.016	0.038	



Dimensional features of single acting cylinders

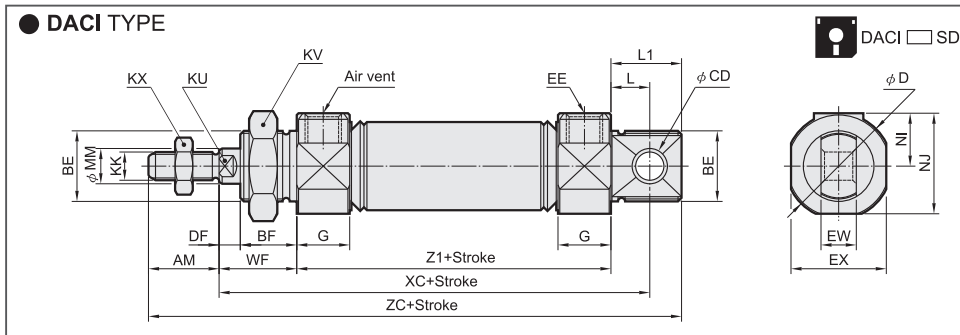

Dimensional Table

Bore	AM	BE	BF	CD	D	DF	EE	EX	EW	G	KK	KV	KX
φ 20	20	M20 × 1.5	16	8	30	6	G1/8	27	10	15	M8 × 1.25	27	14
φ 30	20	M26 × 1.5	18	10	38	8	G1/8	35	12	16	M10 × 1.25	32	17
φ 40	23	M33 × 2.0	20	10	48	8	G1/4	-	20	21.5	M14 × 1.5	41	22

Bore	L	L1	MM	NI	NJ	WF	Stroke 1~50			Stroke 51~100		
							XC	Z1	ZC	XC	Z1	ZC
φ 20	11	20	10	15	28.5	22	97	64	126	122	89	151
φ 30	15	25	12	19	36.5	26	114	73	144	139	98	169
φ 40	15	27	16	-	-	28	129	86	164	154	111	189

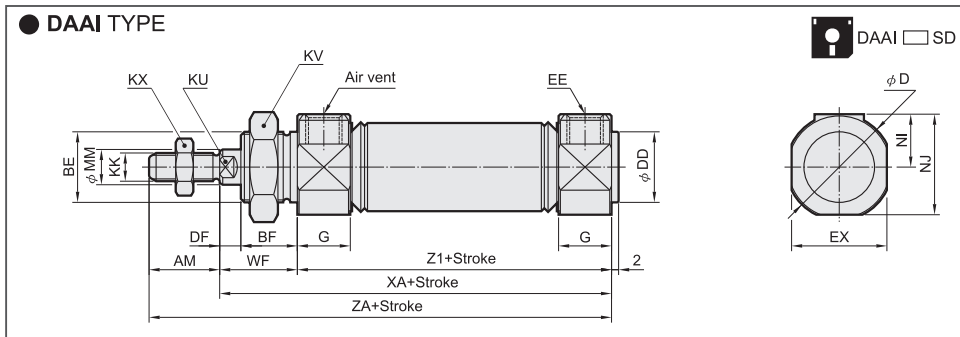

Dimensional Table

Bore	AM	BE	BF	D	DF	DD	EE	EX	G	KK	KV	KX
φ 20	20	M20 × 1.5	16	30	6	20	G1/8	27	15	M8 × 1.25	27	14
φ 30	20	M26 × 1.5	18	38	8	26	G1/8	35	16	M10 × 1.25	32	17
φ 40	23	M33 × 2.0	20	48	8	33	G1/4	-	21.5	M14 × 1.5	41	22

Bore	MM	NI	NJ	WF	Stroke 1~50			Stroke 51~100		
					XA	Z1	ZA	XA	Z1	ZA
φ 20	10	15	28.5	22	86	64	106	111	89	131
φ 30	12	19	36.5	26	99	73	119	124	98	144
φ 40	16	-	-	28	114	86	137	139	111	162

- DA
- DP
- DS
- DQ
- DB
- DN
- BN
- ST
- NT
- DU
- DJ
- TA
- GP
- GS
- GM
- GT
- RT
- CT
- CH

Mounting Dimension of single Acting Cylinders

● FB(FA) TYPE

Bore φ 20, φ 30

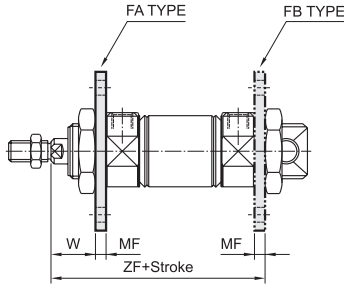
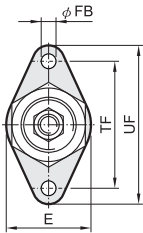

Bore φ 40

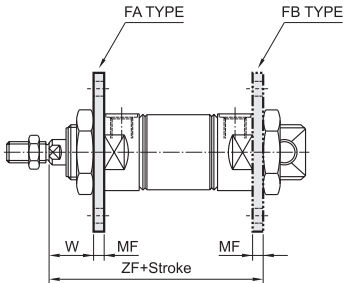
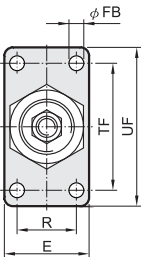

● LB TYPE

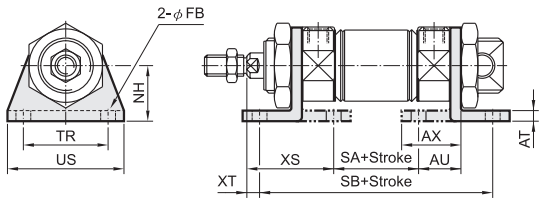

● CU TYPE

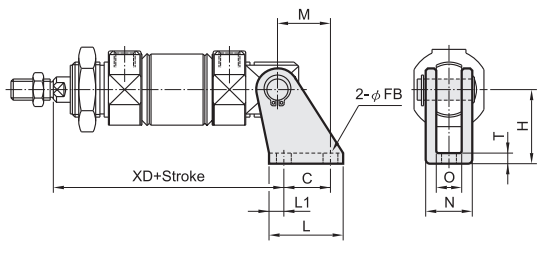

Dimensional Table



Type	Bore	E	FB	MF	R	TF	UF
FA-20	φ 20	40	7	5	-	60	75
FA-30	φ 30	40	7	5	-	60	75
FA-40	φ 40	50	9	5	30	80	100

Type	Bore	W	ZF	
			Stroke 1-50	Stroke 51-100
FA-20	φ 20	17	91	116
FA-30	φ 30	21	104	129
FA-40	φ 40	23.5	118.5	143.5

Dimensional Table



Type	Bore	AT	AU	AX	FB	NH	TR	US
LB-20	φ 20	5	20	28	7	23	40	55
LB-30	φ 30	5	20	28	7	26	40	55
LB-40	φ 40	5	20	30	9	40	50	75

Type	Bore	XT	XS	Stroke 1-50		Stroke 51-100	
				SA	SB	SA	SB
LB-20	φ 20	2	37	34	106	62	131
LB-30	φ 30	6	41	43	119	68	144
LB-40	φ 40	8	43.5	55	134	80	159

Dimensional Table



Type	Bore	C	FB	H	L	L1	M
CU-20	φ 20	20	7	30	32	6	16
CU-30	φ 30	25	7	40	40	7.5	20
CU-40	φ 40	25	9	40	40	7.5	20

Type	Bore	N	O	T	XD	
					Stroke 1-50	Stroke 51-100
CU-20	φ 20	24	16	4	93	118
CU-30	φ 30	28	20	4	109	134
CU-40	φ 40	28	20	4	124	149



Dimensional features of single acting cylinders

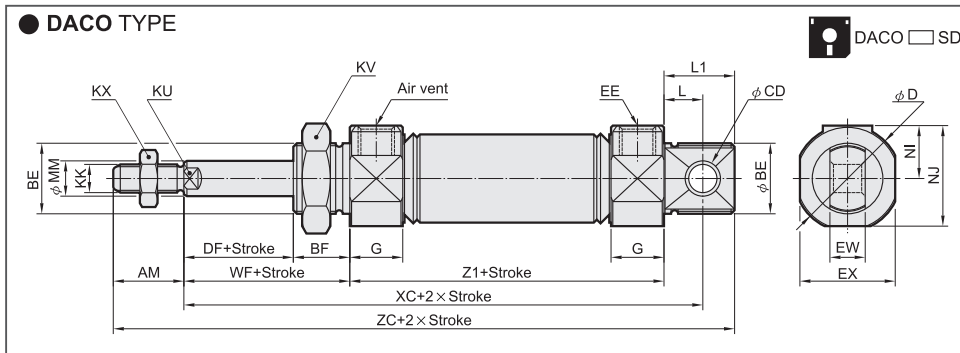

Dimensional Table

Bore	AM	BE	BF	CD	D	DF	EE	EX	EW	G	KK	KV	KX
φ 20	20	M20×1.5	16	8	30	6	G1/8	27	10	15	M8×1.25	27	14
φ 30	20	M26×1.5	18	10	38	8	G1/8	35	12	16	M10×1.25	32	17
φ 40	23	M33×2.0	20	10	48	8	G1/4	-	20	21.5	M14×1.5	41	22

Bore	L	L1	MM	NI	NJ	WF	Stroke 1-50			Stroke 51-100		
							XC	Z1	ZC	XC	Z1	ZC
φ 20	11	20	10	15	28.5	22	97	64	126	122	89	151
φ 30	15	25	12	19	36.5	26	114	73	144	139	98	169
φ 40	15	27	16	-	-	28	129	86	164	154	111	189

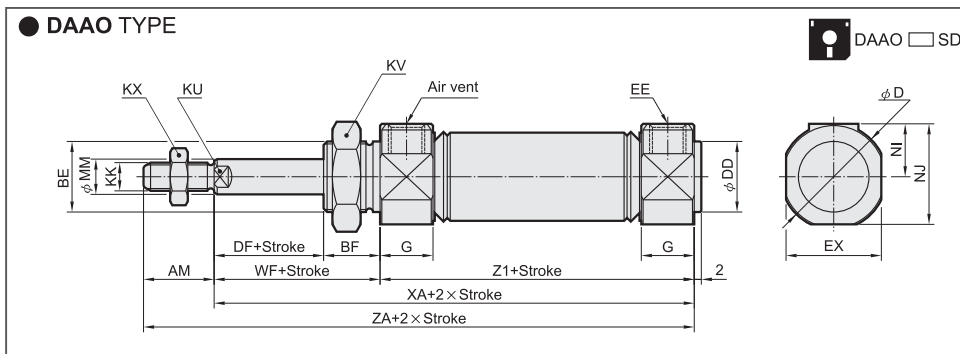

Dimensional Table

Bore	AM	BE	BF	D	DD	DF	EE	EX	G	KK	KV	KX
φ 20	20	M20×1.5	16	30	20	6	G1/8	27	15	M8×1.25	27	14
φ 30	20	M26×1.5	18	38	26	8	G1/8	35	16	M10×1.25	32	17
φ 40	23	M33×2.0	20	48	33	8	G1/4	-	21.5	M14×1.5	41	22

Bore	MM	NI	NJ	WF	Stroke 1-50			Stroke 51-100		
					XA	Z1	ZA	XA	Z1	ZA
φ 20	10	15	28.5	22	86	64	106	111	89	131
φ 30	12	19	36.5	26	99	73	119	124	98	144
φ 40	16	-	-	28	114	86	137	139	111	162

- DA
- DP
- DS
- DQ
- DB
- DN
- BN
- ST
- NT
- DU
- DJ
- TA
- GP
- GS
- GM
- GT
- RT
- CT
- CH



Mounting Dimension of single Acting Cylinders

● **FA(FB) TYPE**

Bore φ 20, φ 30

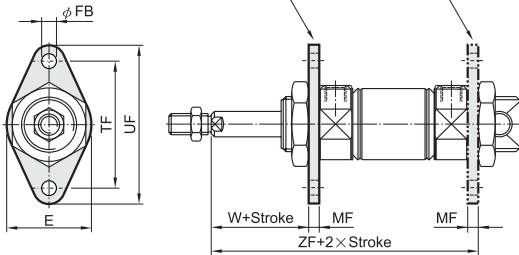

Bore φ 40

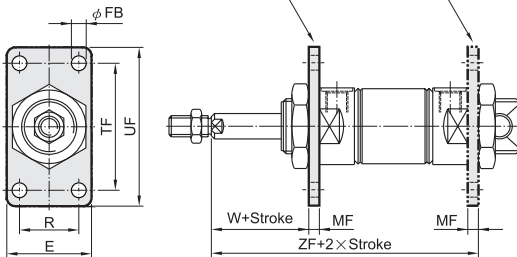

● **LB TYPE**

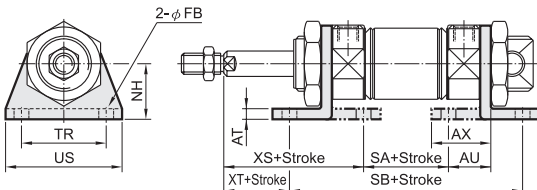

● **CU TYPE**

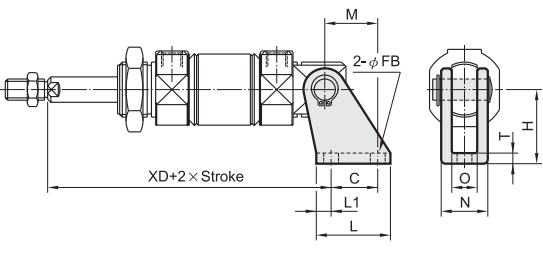

Dimensional Table



Type	Bore	E	FB	MF	R	TF	UF
FA-20	φ 20	40	7	5	-	60	75
FA-30	φ 30	40	7	5	-	60	75
FA-40	φ 40	50	9	5	30	80	100

Type	Bore	W	ZF	
			Stroke 1-50	Stroke 51-100
FA-20	φ 20	17	91	116
FA-30	φ 30	21	104	129
FA-40	φ 40	23.5	118.5	143.5

Dimensional Table



Type	Bore	AT	AU	AX	FB	NH	TR	US
LB-20	φ 20	5	20	28	7	23	40	55
LB-30	φ 30	5	20	28	7	26	40	55
LB-40	φ 40	5	20	30	9	40	50	75

Type	Bore	XT	XS	Stroke 1-50		Stroke 51-100	
				SA	SB	SA	SB
LB-20	φ 20	2	37	34	106	59	131
LB-30	φ 30	6	41	43	119	68	144
LB-40	φ 40	8	43.5	55	134	80	159

Dimensional Table



Type	Bore	C	FB	H	L	L1	M	N	O
CU-20	φ 20	20	7	30	32	6	16	24	16
CU-30	φ 30	25	7	40	40	7.5	20	28	20
CU-40	φ 40	25	9	40	40	7.5	20	28	20

Type	Bore	T	XD	
			Stroke 1-50	Stroke 51-100
CU-20	φ 20	4	93	118
CU-30	φ 30	4	109	134
CU-40	φ 40	4	124	149

Dimensional features

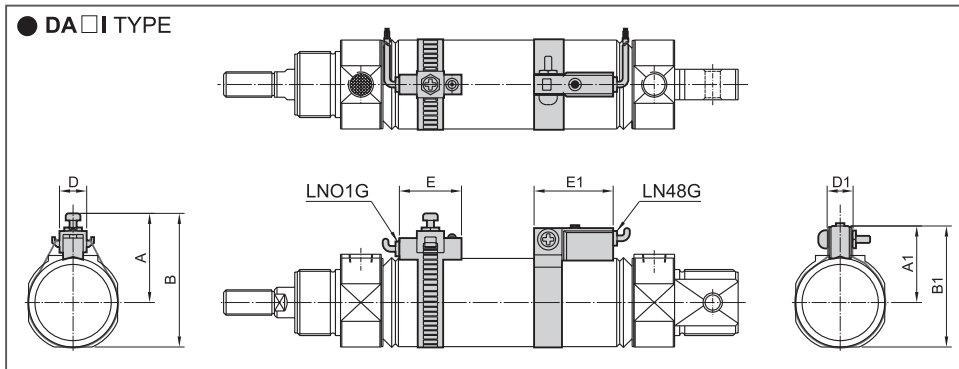

Dimensional Table

Bore	Sensor switch	A	B	D	E	Bore	Sensor switch	Clamp NO.	A1	B1	D1	E1
φ 20	LN01G	28	40.5	7	22	φ 20	LN48G	BS-A20	22	34.5	8	28
φ 30	LN01G	33	50.5	7	22	φ 30	LN48G	BS-A30	27	44.5	8	28
φ 40	LN01G	38	60.5	7	22	φ 40	LN48G	BS-A40	32	54.5	8	28

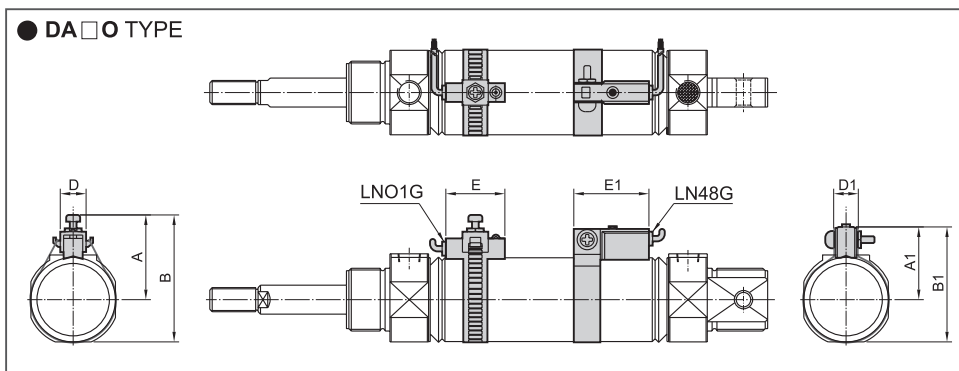

Cylinder Weight (Including The Mounting Nut)

Unit: kg

Bore	Basic weight	Stroke 25 mm	Basic weight	Stroke 25 mm	Basic weight	Stroke 25 mm	Basic weight	Stroke 25 mm
	DACI	DACI	DACO	DACO	DAAI	DAAI	DAAO	DAAO
φ 20	0.141	0.028	0.145	0.028	0.135	0.028	0.139	0.028
φ 30	0.345	0.040	0.350	0.040	0.331	0.040	0.336	0.040
φ 40	0.610	0.072	0.635	0.072	0.570	0.072	0.336	0.072

Mounting weight

Unit: kg

Bore	FA	FB	LB	CU	Y	I	G	K	Nut(Rod)	Nut(Cover)	Sensor switch	
											LN01G	LN48G
φ 20	0.052	0.169	0.064	0.046	0.044	0.053	0.061	0.005	0.020	0.030	0.030	
φ 30	0.061	0.173	0.089	0.088	0.080	0.080	0.113	0.008	0.022	0.030	0.030	
φ 40	0.132	0.315	0.090	0.090	0.157	0.175	0.245	0.016	0.038	0.030	0.030	

- DA
- DP
- DS
- DQ
- DB
- DN
- BN
- ST
- NT
- DU
- DJ
- TA
- GP
- GS
- GM
- GT
- RT
- CT
- CH

Accessories

● Y Rod Clevis (With Pin)

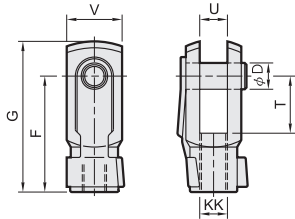

● I Rod end mounting

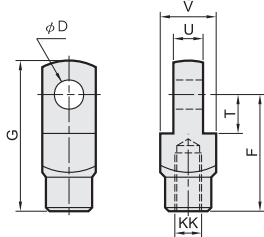

● Oscillating Eye

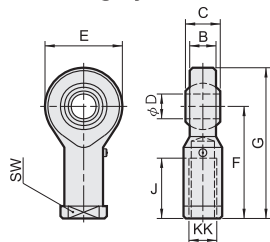

● Compensating Joint

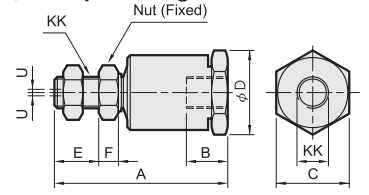

● Mounting Nut

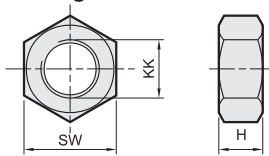

Dimensional Table

Type	Bore	D	F	G	KK	T	U	V
Y-M8 × 1,25	φ 20	8	32	42	M8 × 1,25	16	8	16
Y-M10 × 1,25	φ 30	10	40	52	M10 × 1,25	20	10	20
Y-M14 × 1,5	φ 40	10	45	58	M14 × 1,5	20	14	25



Type	Filename
Y-M8 × 1,25	YM08125
Y-M10 × 1,25	YM10125
Y-M14 × 1,5	YM14150

Dimensional Table

Type	Bore	D	F	G	KK	T	U	V
I-M8 × 1,25	φ 20	8	32	42	M8 × 1,25	11	8	16
I-M10 × 1,25	φ 30	10	40	52	M10 × 1,25	13	10	19
I-M14 × 1,5	φ 40	10	45	57	M14 × 1,5	13	14	25,4



Type	Filename
I-M8 × 1,25	IM08125
I-M10 × 1,25	IM10125
I-M14 × 1,5	IM14150

Dimensional Table

Type	Bore	B	C	D	E	F	G	J	KK	SW
G-M8 × 1,25	φ 20	9	12	8	22	36	47	17	M8 × 1,25	14
G-M10 × 1,25	φ 30	10,5	14	10	26	43	56	21	M10 × 1,25	17
G-M14 × 1,5	φ 40	13,5	19	14	34	57	74	27	M14 × 1,5	22



Type	Filename
G-M8 × 1,25	GM08125
G-M10 × 1,25	GM10125
G-M14 × 1,5	GM14150

Dimensional Table

Type	Bore	A	B	C	D	E	F	KK	U
K-M8 × 1,25	φ 20	47	11	19	20	14,5	5	M8 × 1,25	0,75
K-M10 × 1,25	φ 30	54	13	24	25,5	14,5	6	M10 × 1,25	1
K-M14 × 1,5	φ 40	70	17	29	31	19	8	M14 × 1,5	1,15



Type	Filename
K-M8 × 1,25	KM08125
K-M10 × 1,25	KM10125
K-M14 × 1,5	KM14150

Dimensional Table

Type	Bore	H	KK	SW	Type	Filename
N-M8 × 1,25	φ 20	5	M8 × 1,25	14	N-M8 × 1,25	NM08125
N-M10 × 1,25	φ 30	6	M10 × 1,25	17	N-M10 × 1,25	NM10125
N-M14 × 1,5	φ 40	7	M14 × 1,5	22	N-M14 × 1,5	NM14150
N-M20 × 1,5	φ 20	8	M20 × 1,5	27	N-M20 × 1,5	NM20150
N-M26 × 1,5	φ 30	8	M26 × 1,5	32	N-M26 × 1,5	NM26150
N-M33 × 2,0	φ 40	8	M33 × 2,0	41	N-M33 × 2,0	NM33200

